

# CCTvenues

## CCT Venues-Barbican



Experts in Event Space

Rooms	Size and location	Minimum numbers	Maximum Theatre style		Maximum Classroom style		Maximum Round Cabaret style (tables of 6)		Maximum Square Cabaret style (tables of 6)		Maximum U Shape style		Maximum Board style
			Portrait	Landscape	Portrait	Landscape	Portrait	Landscape	Portrait	Landscape	Portrait	Landscape	
Jupiter/Saturn	15.2m x 7.8m Third Floor	48	115	-	66	-	60	-	48	-	42	-	48
Jupiter	5.1m x 7.8m Third Floor	16	40	-	28	-	24	-	18	-	18	-	22
Saturn	10.1m x 7.8m Third Floor	35	70	-	46	-	36	-	30	-	28	-	36
Neptune/Pluto	18.6m x 5.8m Third Floor	44	100	-	78	-	66	-	54	-	52	-	56
Neptune	14.5m x 5.8m Third Floor	35	80	-	62	-	54	-	42	-	40	-	44
Pluto	4.1m x 5.8m Third Floor	8	18	-	12	-	12	-	-	-	10	-	12
Apollo Suite	14.8m x 7.8m Second Floor	44	115	120	64	66	60	66	48	54	42	30	48
Apollo 1 & 2	9.8m x 7.8m Second Floor	30	70	70	40	46	36	36	30	36	26	22	32
Apollo 2 & 3	9.8m x 7.8m Second Floor	30	-	70	-	46	-	36	-	36	-	22	32
Apollo 1	4.9m x 7.8m Second Floor	16	40	-	28	-	24	-	18	-	18	-	22
Apollo 2	4.9m x 7.8m Second Floor	16	40	-	28	-	24	-	18	-	18	-	22
Apollo 3	4.9m x 7.8m Second Floor	16	40	-	28	-	24	-	18	-	18	-	22
Discovery	10.2m x 7.8m Second Floor	30	70	80	46	46	36	36	30	30	26	22	30
Atlantis	9.5m x 5.8m Second Floor	24	64	-	40	-	36	-	30	-	24	-	30
Electra	8.0m x 6.3m First Floor	20	50	-	30	-	30	-	24	-	22	-	24
Uranus	7.8m x 5.1m Third Floor	16	40	-	28	-	24	-	18	-	18	-	22
Venus	7.6m x 4.6m Fourth Floor	14	40	-	24	-	24	-	18	-	16	-	20
Eris	5.6m x 5.5m First Floor	10	24	-	16	-	16	-	12	-	14	-	16
Polaris 2	5.6m x 4.9m First Floor	10	28	-	16	-	16	-	12	-	12	-	16
Polaris 1	5.6m x 4.3m First Floor	10	21	-	12	-	12	-	12	-	10	-	16
Luna	5.8m x 4.9m Second Floor	10	20	-	14	-	18	-	12	-	12	-	16
Earth	5.4m x 4.9m Fourth Floor	10	20	-	14	-	18	-	-	-	12	-	16
Mars	5.4m x 4.9m Fourth Floor	10	20	-	14	-	18	-	-	-	12	-	16
Vega	5.1m x 5.1m First Floor	8	20	-	12	-	12	-	-	-	12	-	12
Rana	5.1m x 5.1m First Floor	8	16	-	10	-	-	-	-	-	6	-	8
Altair	5.0m x 2.9m First Floor	4	9	-	-	-	-	-	-	-	-	-	8
Avior	5.0m x 2.9m First Floor	4	9	-	-	-	-	-	-	-	-	-	8
Mira	3.5m x 3.5m First Floor	4	-	-	-	-	-	-	-	-	-	-	6
Sun Restaurant Standing capacity - 150	118m <sup>2</sup> Fourth floor	-	-	-	-	-	-	-	-	-	-	-	-

- Located next to Barbican Underground station, and a short walk from Farringdon, St Paul's and Moorgate
- 22 flexible rooms
- Perfect for small to medium sized events

- Includes a spacious, modern top floor restaurant with excellent catering and city views for up to 120 people
- Superb AV equipment available, and high-speed data connections

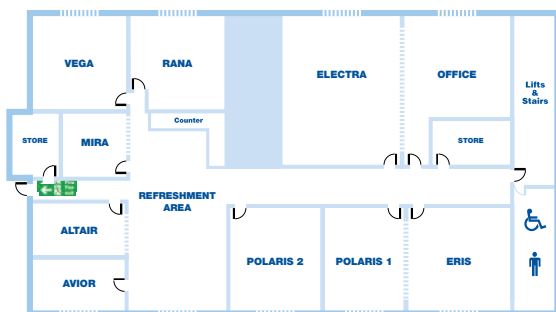

First floor

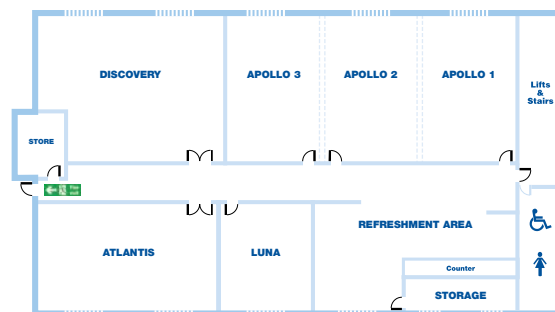

Second floor

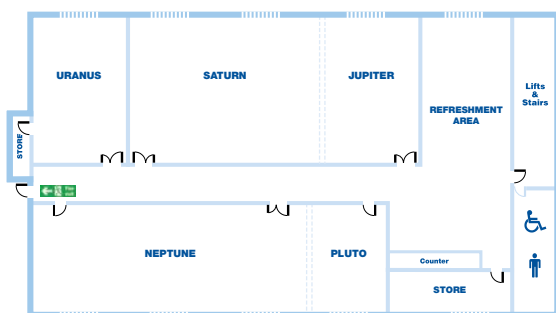

Third floor

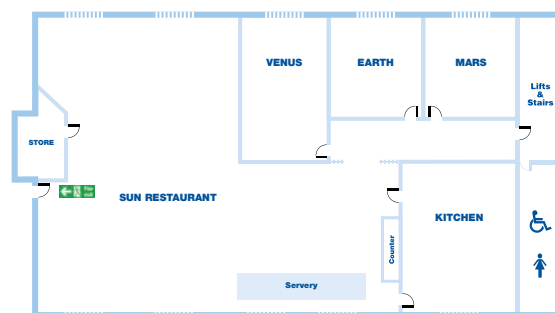

Fourth floor

For bookings and enquiries:

**T: 0808 168 1168 E: [enquire@cctvenues.co.uk](mailto:enquire@cctvenues.co.uk)**

CCT Venues-Barbican, Aldersgate House, 135-137 Aldersgate Street, London, EC1A 4JA