

Hotel Bel-Air
Garden Ballroom
Ground floor

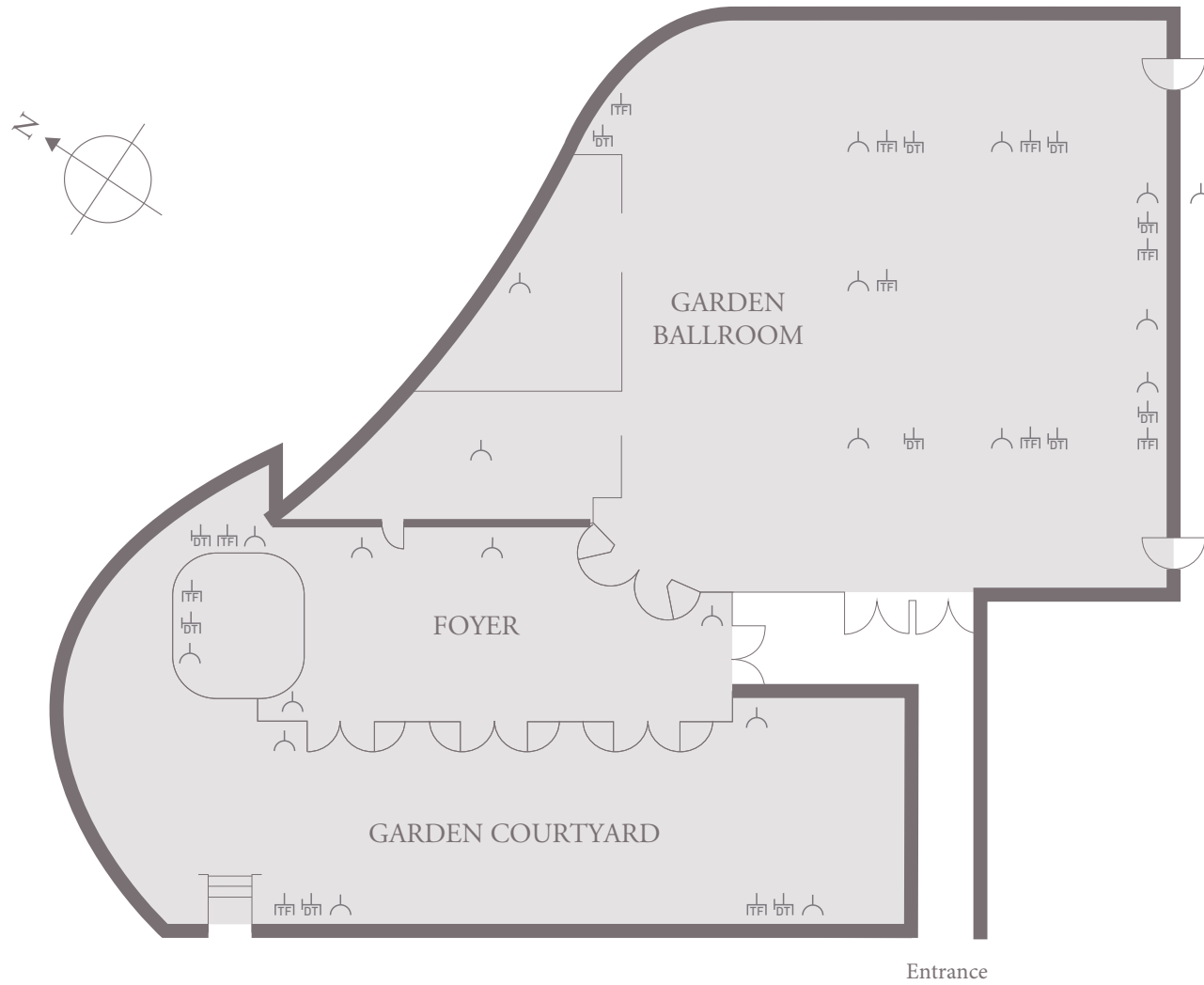

GARDEN BALLROOM	Metres	Feet
Area	247m ²	2,660ft ²
Ceiling height – centre	4.5m	15'
Ceiling height – sides	4m	13'
Ceiling height – stage	3m	10'
Length (maximum)	15m	49'2"
Width (maximum)	15m	49'2"

GARDEN FOYER	Metres	Feet
Area	69m ²	747ft ²
Ceiling height	2.4m	8'
Length (maximum)	12m	39'4"
Width (maximum)	5m	16'4"

GARDEN COURTYARD	Metres	Feet
Area	111m ²	1,198ft ²
Ceiling height	2.7m	9'
Length (maximum)	20m	65'6"
Width (maximum)	4m	13'1"

Key	Symbol
Electricity socket	
LAN port	
Telephone socket	