

PERFECT PARTNERSHIP MEETINGS & EVENTS

AT FIVE LAKES RESORT



FIVE LAKES
RESORT





OUR RESORT

*Nestled in the beautiful Essex countryside,
just nine miles off the A12, you'll find
the unique destination venue of
Five Lakes Resort.*

*We offer visitors just that little bit more.
A difference you'll appreciate.*

*If you can visualise it, we can help you pull
it off. Just think of us as a blank canvas,
whatever your plans. From four people to
4,000, we're here to make it happen. The
only limit is your imagination.*

*The sheer versatility of our 15 meeting rooms
means we're the perfect place to bring people
together. Our huge event arena can take
anything you can throw at it. The
wide open spaces of our glorious grounds
are ideal for any activity you want to thrill
clients, or create an unforgettable team
building experience.*

*Where better to throw off the shackles, and
re-energise your business brain?*



THE SPECIALISTS FOR YOUR SPECIAL EVENT

Whatever you're looking to organise, we understand it's your event, you're in charge, and what you say goes. But what sort of hosts would we be if we let you go it alone?

From the moment you get in touch, your very own meetings co-ordinator is here to make sure everything runs, like clockwork. Whatever you dream up, they're up for the challenge – helping you bring your event to life smoothly and making the most of your budget, all while sprinkling a little magic along the way.

"The feedback I've had is that the event went really well, and everyone was very happy. I've even been told it was our best summer conference yet! Personally, I've only got positive things to say. The day ran really smoothly and I can't thank you enough for your hard work in making sure it did."



TEAM BUILDING



Nothing builds team spirit better than getting away from the office and pitching up in the lovely setting of Five Lakes. You're guaranteed a great place to focus your team with plenty of fun and laughter along the way. Think facilities and you've hit the jackpot. Wake up and smell the coffee in our on-site Starbucks, slake your thirst in the Manhattan-style Lacu Bar, and enjoy tasty dishes and the elegant ambience of our Brasserie¹ restaurant. And, once you've had your fill, you can hit the gym or take a dip in our inviting indoor swimming pool, or how about a good pampering in our spa?

If it's a bit of friendly competition you're after, you're in the right place, too. Golf, football, tennis, squash, table tennis – that's the ball skills tested. We've also got jogging tracks threaded around the property.

SUITE SUCCESS

THE MERSEA SUITE

Need to seat up to 400 people in grand, theatre-style seating? You need our Mersea Suite. Newly refurbished, it has a fresh look and feel that's designed to wow. With technical coloured lighting we can even create the mood and colour to match your brand. You've got everything you need, whatever you're planning. Let everyone mingle and keep them entertained in the comfortable bar, or fling open the doors for fresh air and fantastic views on the terrace. We're nothing if not flexible, too. Want to partition the room for 100 people? No problem.

THE RUSHLEY SUITE

There are two sides to Rushley. Choose one of the distinct spaces – Rushley One or Rushley Two – or use them together to create something special. With its own bar, dance floor and balcony overlooking our glorious gardens, the light and airy Rushley One is perfect for private dining for up to 100 guests, while Rushley Two is brilliant for drinks receptions, or as a comfy lounge area.

THE EXECUTIVE BOARDROOM

Release your inner Chairman in our Executive Boardroom. Perfect for up to 14 people to slide their feet under the table, bounce ideas around and get down to business. All with the conference facilities you'd expect, and a stunning backdrop from the private balcony. There's even a cosy breakout room next door.

THE WALLASEA SUITE

Tucked away for privacy, this theatre-style suite makes hosting 160 people a breeze. There's a great bar to loosen everybody up, too. Another really flexible space, we can divide it into two rooms for 80, if that's what you need. Just let us know.

THE RAMSEY SUITE

This is the place for those smaller, more intimate meetings or get-togethers. There are three rooms to play with, all getting plenty of natural light, and you can choose to use them as a 90-seat theatre-style room, or create your own boardroom-style room for 45.

THE NORTHEY AND OSEA SUITE

Two rooms, both with 40 theatre-style seats, the Northey Suite and Osea Suite are perfect for creating that relaxed environment to tickle the brain and let those creative ideas flow. They also make excellent break-out or small meeting rooms.

"I'd like to thank everyone involved with our training event. Everything was exactly as we expected. You even arranged the weather. We all had a fantastic event and I've had lots of positive feedback. The food and drink were excellent – although there were a few sore heads on the Friday morning!"

MLM Building

The background image shows a vast indoor arena with a high, vaulted ceiling supported by a network of dark metal beams. Numerous pendant lights hang from the ceiling, illuminating the space. In the foreground and middle ground, rows of yellow wooden chairs are arranged on a grey carpeted floor. Each chair has a small, clear plastic bottle of water placed on its seat. In the background, white partition walls are visible, and a small model of an airplane is suspended from the ceiling on the right side.

THE ARENA

How do you fancy over 3,500 square metres of open space to play with? You've come to the right place. The Arena holds up to 2,500 people, and is big enough to drive a double decker bus into – if you want to, of course. Just one more reason why Five Lakes Resort is a unique venue.

So, if you're planning an exhibition or a product launch, a dinner dance or a wedding, or even a fun team building day, look no further.

You want flexibility, you say? Well, you've got it. The Arena is whatever you want it to be. We can even divide it into three sections. Don't fret about parking or hitting the sack after a busy day, there are 500+ parking spots and loads of luxurious accommodation for your guests – all set in 320 acres of lush, rolling countryside.

What's not to like?

MORE THAN THE REST...

We've designed all our rooms to the tiniest detail. So relax in comfort with those extra touches that make all the difference. Sink into a deep bath, slip into a sumptuous bed, enjoy the softest duvets and treat yourself to as many extra pillows as you like.

All of our 194 rooms have en suite bathrooms, with piping hot showers and baths to soak in, and carefully hand-picked soaps to enjoy.

"I've organised many conferences for our people and the main venue and break out rooms were the best we've ever used, by far. They were totally suitable for our needs, and were set up exactly as we pictured them. It was great that we didn't have to ask for changes."

SKY



A TASTE FOR THE FINER THINGS

There's never a shortage of something tasty to eat or drink at Five Lakes. How about kick-starting your day at Starbucks, or setting yourself up with a delicious plate of locally sourced bacon and freshly prepared eggs?

Just finished a round of golf? Celebrate or commiserate with a tasty snack or glass of beer in the Sports Bar. Or if it's cocktails you're after, you can clink glasses to your hearts content in Bar Lacu. Then sit back with a glass of wine and tuck into traditional British dishes, served to perfection in Brasserie1.

"An enjoyable event was had by all, and we were very well looked after. The evening BBQ was well received with celebrations into the early hours, while the training day ran smoothly, despite a few sore heads from the night before. Thanks for all your help over the last few months and please pass our thanks onto your team."





GOLF

If golf's your bag, check out our two distinct courses. Not only are they set in glorious undulating parkland, their tees and greens are built to USGA spec. How's that for marking your card? With a Links course and a Lakes course, you can really put those skills to the test, and prepare for bragging rights at the 19th hole.

Looking to improve your swing? Head to the driving range or our golf pro's are on hand to give you hints and tips to perfect your game with our golf clinics.

We have a fleet of golf buggies ready to hire and the latest golf equipment to purchase in our golf pro shop.



SPA

Feel the cares of your busy 21st century life melt away, when you treat yourself and a loved one to a special spa break to soothe the soul. Choose a day or overnight package, then get away for a bit of well-deserved TLC. Go on, you know you want to...

However long you're with us, our spa is yours to enjoy until you're ready to take on the world once more.



GREAT IDEAS. YOU JUST NEVER KNOW
WHEN THEY'LL COME TO YOU.

LOWER GROUND FLOOR SUITES

WALLASEA SUITE

The Wallasea Suite is located on the lower ground floor and can cater for up to 160 delegates theatre style. This private suite offers a grand size bar and private reception area.

WALLASEA 1 & 2

Designed for flexibility, the Wallasea Suite can be divided into 2 rooms, each holding a maximum of 80 delegates theatre style.

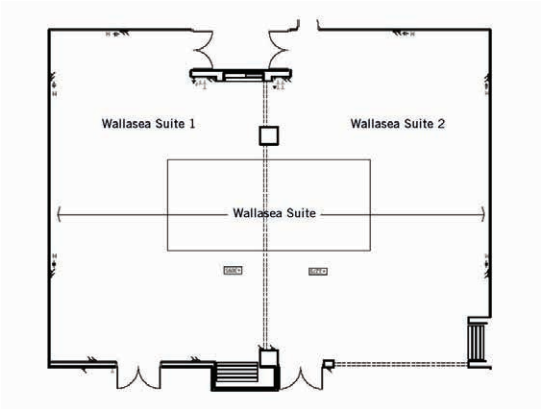

ROOM SIZES & CAPACITIES

ROOM NAME	WALLASEA SUITE	WALLASEA 1	WALLASEA 2
Length ft/m	41' / 12.5	41' / 12.5	41' / 12.5
Width ft/m	54' / 16.4	27' / 8.2	27' / 8.2
Height ft/m	10' / 3.2	10' / 3.2	10' / 3.2
Direct Dial	Yes	Yes	Yes
Natural Daylight	-	-	-
Floor	LG	LG	LG
Vent Type	A/C	A/C	A/C
PA System	No	No	No
Theatre	160	80	80
C'Room	80	40	40
U-shape	45	30	30
Cabaret	84	42	42
Boardroom	50	30	30
Lunch / Dinner	150	80	80
Dinner Dance	120	50	50

GROUND FLOOR SUITES

MERSEA SUITE

Located on the ground floor of the resort with its own terrace and fantastic scenery, this suite caters for up to 400 guests. The Mersea Suite offers natural daylight, a private bar and space for a generous dancefloor with tall ceilings and no pillars.

MERSEA 1, 2 & 3

Designed for flexibility, the Mersea Suite can be divided into three rooms. Each can hold a maximum of 125 delegates for a theatre style set up. Each suite is ideal as a break-out room or for syndicates. The flexibility of the Mersea Suite allows clients to partition off as much or a little as they desire.

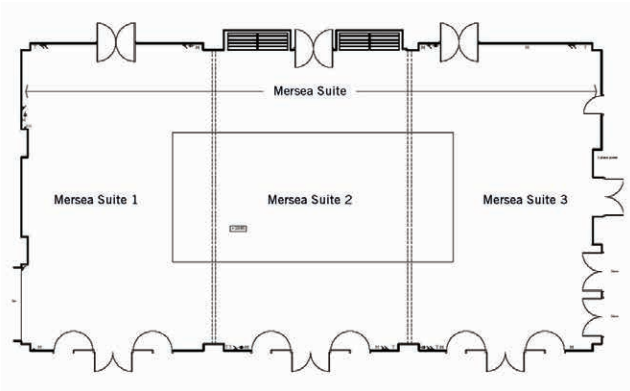

ROOM SIZES & CAPACITIES

ROOM NAME	MERSEA SUITE	MERSEA 1	MERSEA 2	MERSEA 3
Length ft/m	81' / 25.5	27' / 8.3	27' / 8.3	27' / 8.3
Width ft/m	43' / 13.2	43' / 13.2	43' / 13.2	43' / 13.2
Height ft/m	12' / 3.9	12' / 3.9	12' / 3.9	12' / 3.9
Direct Dial	Yes	Yes	Yes	Yes
Natural Daylight	Yes	Yes	Yes	Yes
Floor	G	G	G	G
Vent Type	A/C	A/C	A/C	A/C
PA System	No	No	No	No
Theatre	400	125	125	125
C'Room	150	50	50	50
U-shape	75	40	40	40
Cabaret	126	48	48	48
Boardroom	-	30	30	30
Lunch / Dinner	240	80	80	80
Dinner Dance	250	-	-	-

FIRST FLOOR SUITES

RUSHLEY SUITE

This light and elegant suite can cater for up to 180 guests and incorporates Rushley 1 and 2. The Rushley Suite offers a private bar and space for a dance floor plus its own balcony overlooking the Lakes golf course and gardens.

RUSHLEY 1 & 2

The Rushley Suite can be divided into two rooms. Rushley 2 is a popular choice for holding meetings for up to 30 delegates with Rushley 1 itself used as a private dining option. Each room has a number of benefits and is one of the hotel's most popular suite choices.

EXECUTIVE BOARDROOM

The executive meeting room features state of the art conference facilities with room for up to 14 delegates and a wonderful golf course view and access to a balcony. There is an adjoining lounge area which is ideal for breakout sessions or private catering.

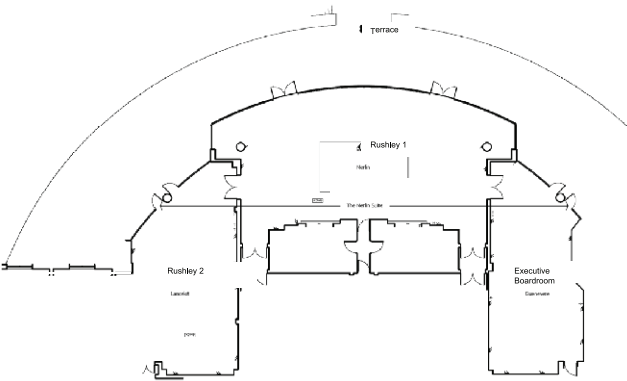

ROOM SIZES & CAPACITIES

ROOM NAME	RUSHLEY SUITE	RUSHLEY 1	RUSHLEY 2	EXECUTIVE BOARDROOM
Length ft/m	-	55' / 16.7	48' / 14.6	48' / 14.6
Width ft/m	-	30' / 9.3	23' / 7.2	18' / 5.4
Height ft/m	-	9' / 2.7	8' / 2.4	8' / 2.4
Direct Dial	Yes	Yes	Yes	Yes
Natural Daylight	Yes	Yes	Yes	Yes
Floor	1st	1st	1st	1st
Vent Type	A/C	A/C	A/C	A/C
PA System	No	No	No	No
Theatre	-	100	90	-
C'Room	-	45	40	-
U-shape	-	30	28	-
Cabaret	-	48	36	-
Boardroom	-	40	30	14
Lunch / Dinner	180	120	60	14
Dinner Dance	-	100	50	-

FIRST FLOOR SUITES

RAMSEY SUITE 1, 2 & 3

These rooms are adjacent to the Rushley 2 and are suitable for small conferences and meetings. All three rooms benefit from natural daylight. Ramsey 1, 2 and 3 combined make up the Ramsey Suite, and can cater for 90 theatre style or a boardroom of 45.

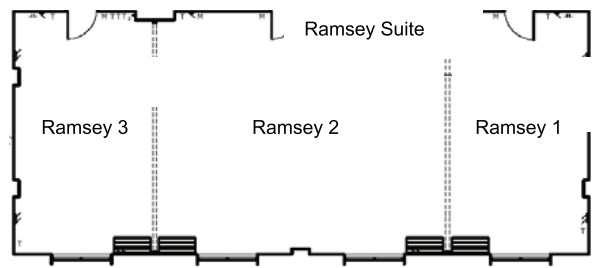

ROOM SIZES & CAPACITIES

ROOM NAME	RAMSEY SUITE	RAMSEY 1 & 3	RAMSEY 2
Length ft/m	53'10" / 16.4	13' / 4	27'6" / 8.4
Width ft/m	23' / 7.1	23' / 7.1	23' / 7.1
Height ft/m	9' / 2.6	9' / 2.6	9' / 2.6
Direct Dial	Yes	Yes	Yes
Natural Daylight	Yes	Yes	Yes
Floor	1st	1st	1st
Vent Type	A/C	A/C	A/C
PA System	No	No	No
Theatre	90	20	40
C'Room	40	-	20
U-shape	40	8	20
Cabaret	42	6	18
Boardroom	45	12	20
Lunch / Dinner	80	10	20
Dinner Dance	60	-	-

FIRST FLOOR SUITES

NORTHEY SUITE - NORTHEY 1 & NORTHEY 2 OSEA SUITE - OSEA 1 & OSEA 2

All rooms offer a more relaxing and informal environment, ideal for break-out rooms or small meetings. The Osea Suite and Northey Suite provide a maximum seating capacity of 40 theatre style.

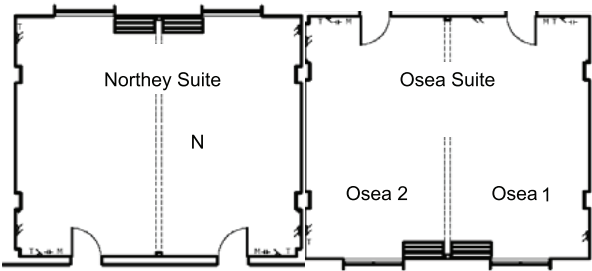

ROOM SIZES & CAPACITIES

ROOM NAME	NORTHEY SUITE	NORTHEY 1 & 2	OSEA SUITE	OSEA 1 & 2
Length ft/m	27'6" / 8.4	13' / 4	27'6" / 8.4	13' / 4
Width ft/m	23' / 7.1	23' / 7.1	23' / 7.1	23' / 7.1
Height ft/m	9' / 2.6	9' / 2.6	9' / 2.6	9' / 2.6
Direct Dial	Yes	Yes	Yes	Yes
Natural Daylight	Yes	Yes	Yes	Yes
Floor	1st	1st	1st	1st
Vent Type	A/C	A/C	A/C	A/C
PA System	No	No	No	No
Theatre	40	20	40	20
C'Room	24	12	24	12
U-shape	20	8	20	8
Cabaret	18	6	18	6
Boardr	20	12	20	12
Lunch / Dinner	20	10	20	10
Dinner Dance	-	-	-	-

YOUR MEETING YOUR WAY

DAY DELEGATE RATE

from £35.00 per person

Includes:

Meeting Room Hire

Delegate Stationery

Water and Sweets

Screen, Projector and Flipchart

Working Buffet Lunch

3 Servings of Refreshment Breaks Including Snacks

Complimentary Wifi

Complimentary Parking



24 HOUR PACKAGE

from £135.00 per person

Includes all features of a Day Delegate plus:

Overnight Accommodation (Standard Bedrooms)

Access to Leisure Facilities

3 Course Dinner in our Brasserie Restaurant

Full English Breakfast





FIVE LAKES
RESORT

01621 862330 | conferences@fivelakes.co.uk | fivelakes.co.uk



Five Lakes Resort Colchester Road Essex CM9 8HX