

FIRST FLOOR

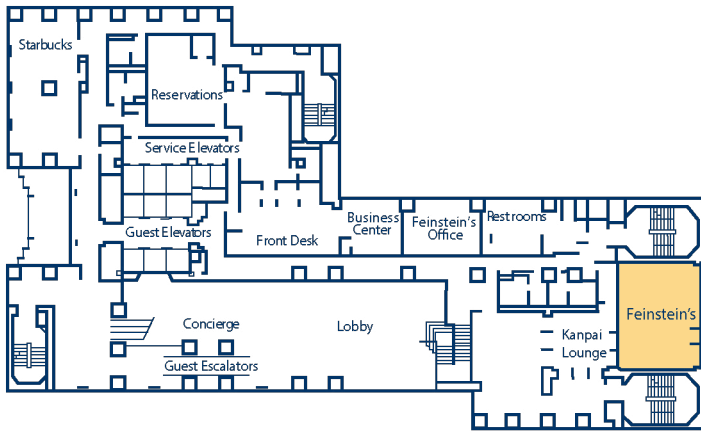

SECOND FLOOR

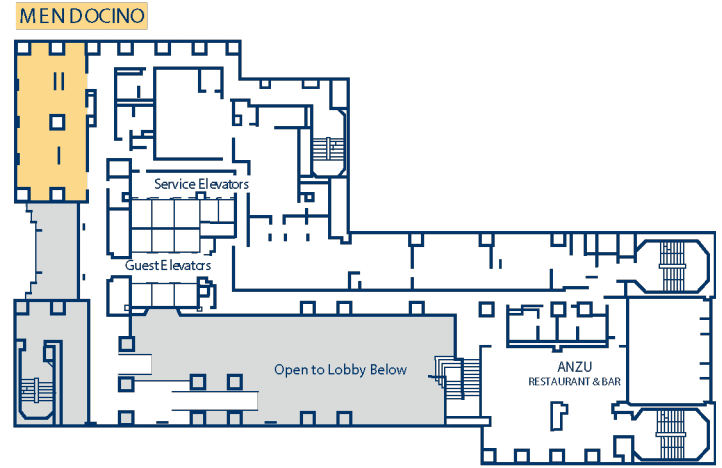

THIRD FLOOR

MONTEREY

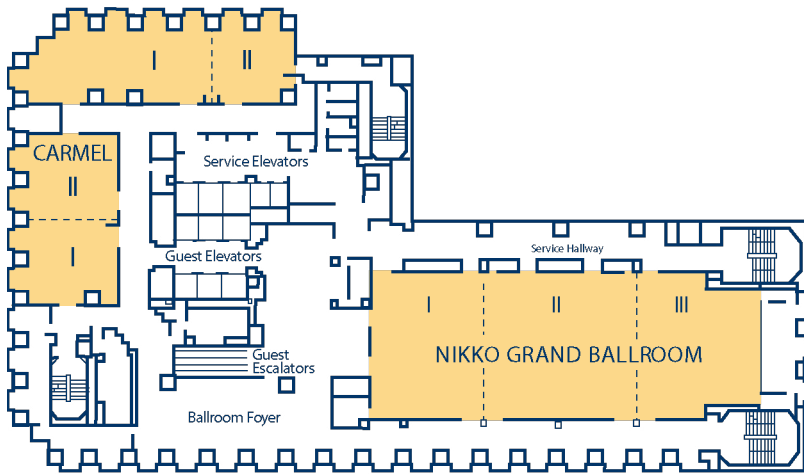

TWENTY-FIFTH FLOOR

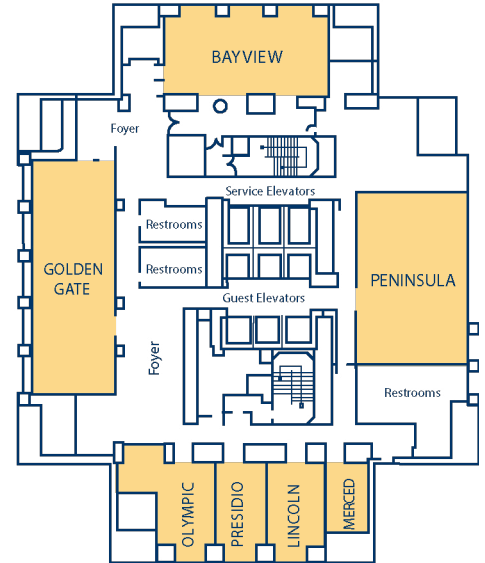

MEETING ROOM	SQ. FT.	HEIGHT	WIDTH	LENGTH	CLASSROOM (2/4)	CLASSROOM (3/6)	HOLLOW SQUARE	U-SHAPE	CONFERENCE	THEATER/ RECEPTION	BANQUET (RND 10)	EXHIBIT (TABLE TOPS)	EXHIBIT (8X10)
FIRST FLOOR													
Feinstein's	1221	-	33'	37'	-	-	-	-	-	175	-	-	-
SECOND FLOOR													
Mendocino	1350	8'10"	25'	54'	46	70	25	20	25	110	100	-	-
Mendocino I	725	8'10"	25'	29'	24	35	25	20	25	70	50	-	-
Mendocino II	625	8'10"	25'	25'	20	30	20	16	20	50	40	-	-
THIRD FLOOR													
Nikko Ballroom	6658	15'7"	48'	145'	350	500	-	-	-	800	600	60	40
Nikko I	1824	15'7"	48'	38'	65	100	54	45	40	175	160	15	9
Nikko II	2544	15'7"	48'	53'	100	150	72	54	46	275	250	23	15
Nikko III	2290	15'7"	48'	54'	75	115	54	38	46	200	170	22	12
3rd Floor Foyer	4916	8'10"	75'	192'	-	-	-	-	-	400	-	45	-
Monterey	2392	8'10"	26'	92'	85	130	86	76	84	240	220	-	-
Monterey I	1638	8'10"	26'	63'	52	80	50	46	52	150	150	-	-
Monterey II	702	8'10"	26'	27'	26	40	36	30	30	80	50	-	-
Carmel	1848	8'10"	33'	56'	66	100	60	51	58	175	150	-	-
Carmel I	924	8'10"	33'	28'	26	40	30	24	30	80	60	-	-
Carmel II	924	8'10"	33'	26'	26	40	30	24	30	80	60	-	-
TWENTY-FIFTH FLOOR													
Golden Gate	1560	8'10"	24'	65'	50	75	54	48	52	150	120	-	-
Bay View	990	8'8"	22'	45'	30	55	36	30	28	100	70	-	-
Peninsula	1200	8'0"	23'4"	40'	45	60	40	36	34	120	90	-	-
Presidio Boardroom	324	8'10"	13'6"	24'	-	-	-	-	15	-	-	-	-
Olympic Boardroom	419	8'10"	15'6"	24'	-	-	-	-	15	-	-	-	-
Lincoln Boardroom	242	8'10"	13'6"	24'	-	-	-	-	15	-	-	-	-
Merced Boardroom	162	8'10"	11'11"	13'4"	-	-	-	-	8	-	-	-	-