

# DYNASTY



# DYNASTY

The Dynasty Hall can be divided into two or three rooms depending on the size and nature of the event.

The Dynasty Hall is equipped with a multi-purpose backdrop batten, a 6.2m-high ceiling, a high-tech banquet and Meeting system, and the know-how of skilled professional staff, making it ideal for high-end events.

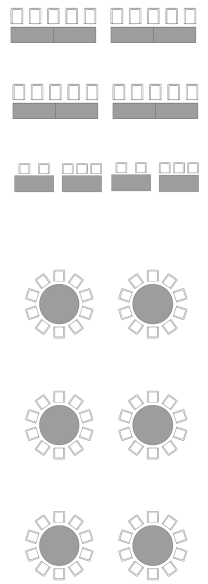
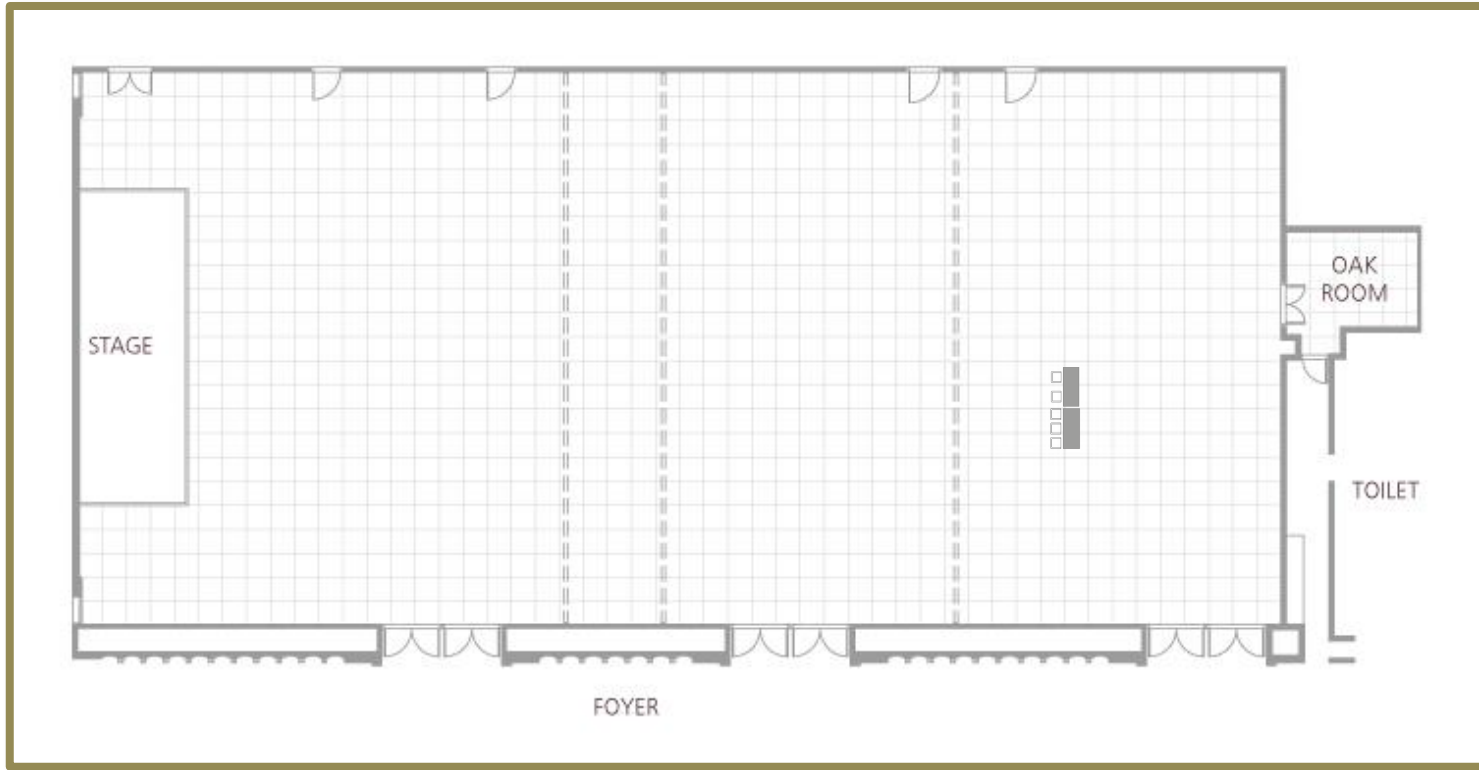

SQM2	PYUNG	AREA	HEIGHT	ROUND TABLE	CLASS ROOM	THEATER	RECEPTION	MIC (ea)	SCREEN (m)	BANNER (m)
1,325	402	23×50	6.2	1000	930	1400	1400	Wire 4 Wireless 4	Front 6×4.5 Middle 8.15×4.6 Side 4×3	Stage 13×1.05

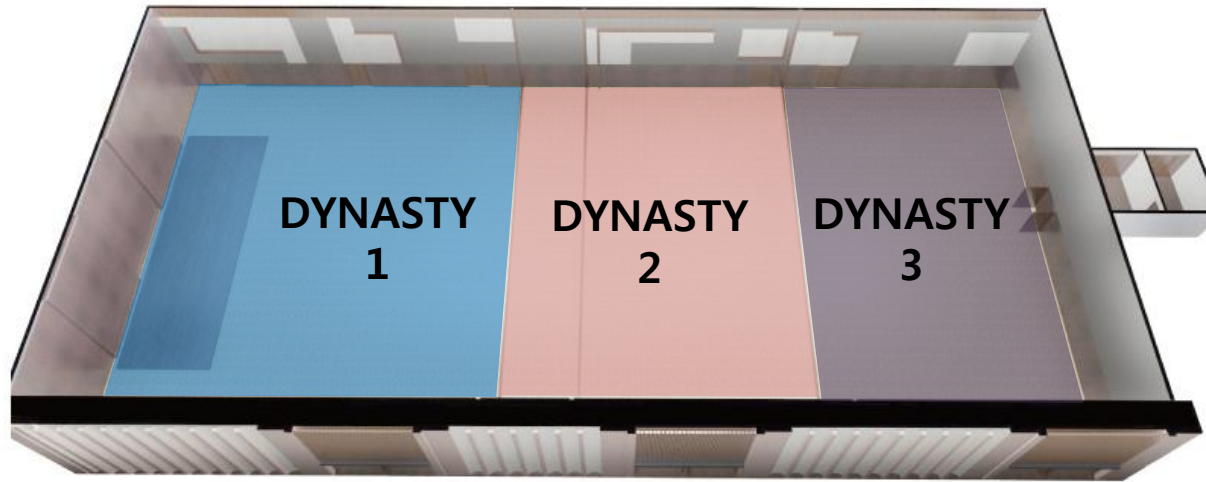

## DYNASTY 1

SQM2	PYUNG	AREA	HEIGHT	ROUND TABLE	CLASS ROOM	THEATER / RECEPTION	MIC (ea)	SCREEN (m)	BANNER (m)
575	174	23×21.6	6.2	420	360	540	Wire 4 Wireless 4	Front 4.6×3 Right 5.2×3.7 Back 4.6×3	8×0.7

## DYNASTY 2

SQM2	PYUNG	AREA	HEIGHT	ROUND TABLE	CLASS ROOM	THEATER / RECEPTION	MIC (ea)	SCREEN (m)	BANNER (m)
400	121	23×16	6.2	300	240	360	Wire 4 Wireless 4	Front 4.6×3 Right 5.2×3.7 Back 4.6×3	8×0.7

## DYNASTY 3

SQM2	PYUNG	AREA	HEIGHT	ROUND TABLE	CLASS ROOM	THEATER / RECEPTION	MIC (ea)	SCREEN (m)	BANNER (m)
350	106	23×13.4	3.6	240	210	300	Wire 4 Wireless 4	Front 4.6×3 Right 5.2×3.7 Back 4.6×3	8×0.7

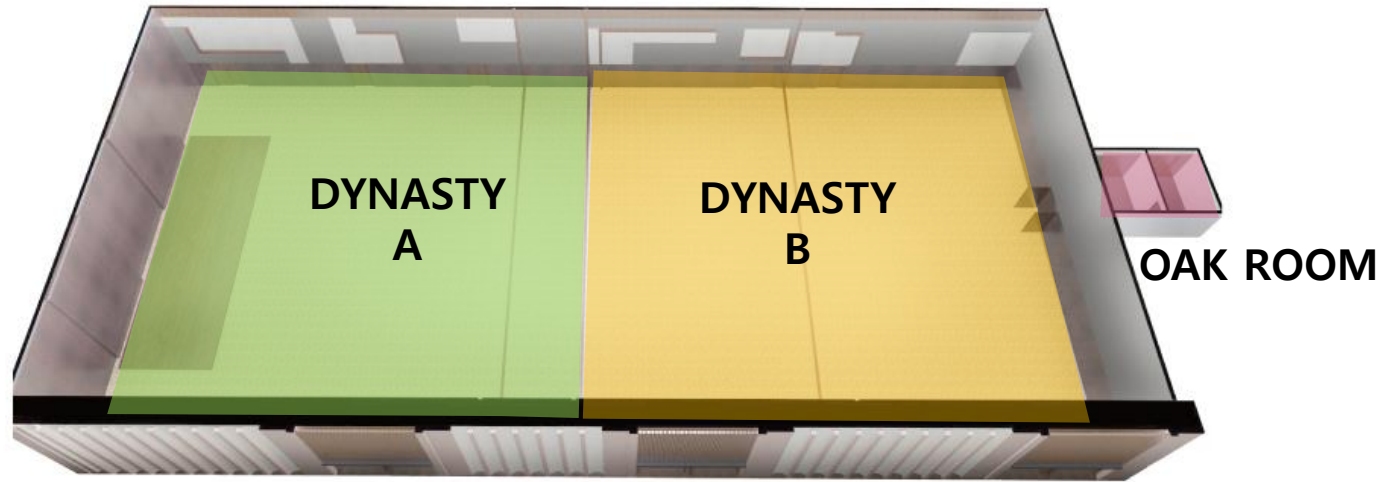

### DYNASTY 1+2

SQM2	PYUNG	AREA	HEIGHT	ROUND TABLE	CLASS ROOM	THEATER / RECEPTION	MIC (ea)	SCREEN (m)	BANNER (m)
975	295	23×37.6	6.2	720	660	1000	Wire 4 Wireless 4	Front 4.6×3 Right 5.2×3.7 Back 4.6×3	8×0.7

### DYNASTY 2+3

SQM2	PYUNG	AREA	HEIGHT	ROUND TABLE	CLASS ROOM	THEATER	MIC (ea)	SCREEN (m)	BANNER (m)
750	227	23×29.4	6.2	540	510	750	Wire 4 Wireless 4	Front 4.6×3 Right 5.2×3.7 Back 4.6×3	8×0.7

### DYNASTY A / DYNASTY B

SQM2	PYUNG	AREA	HEIGHT	ROUND TABLE	CLASS ROOM	THEATER / RECEPTION	MIC (ea)	SCREEN (m)	BANNER (m)
662	201	23×25.5	6.2	480	450	670	Wire 4 Wireless 4	Front 4.6×3 Right 5.2×3.7 Back 4.6×3	8×0.7

# DYNASTY

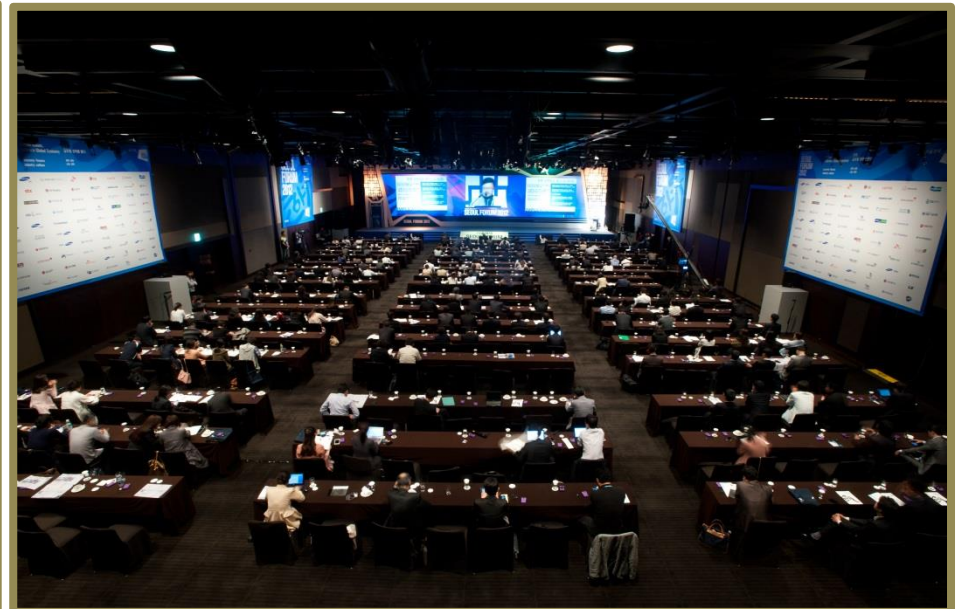

# DYNASTY

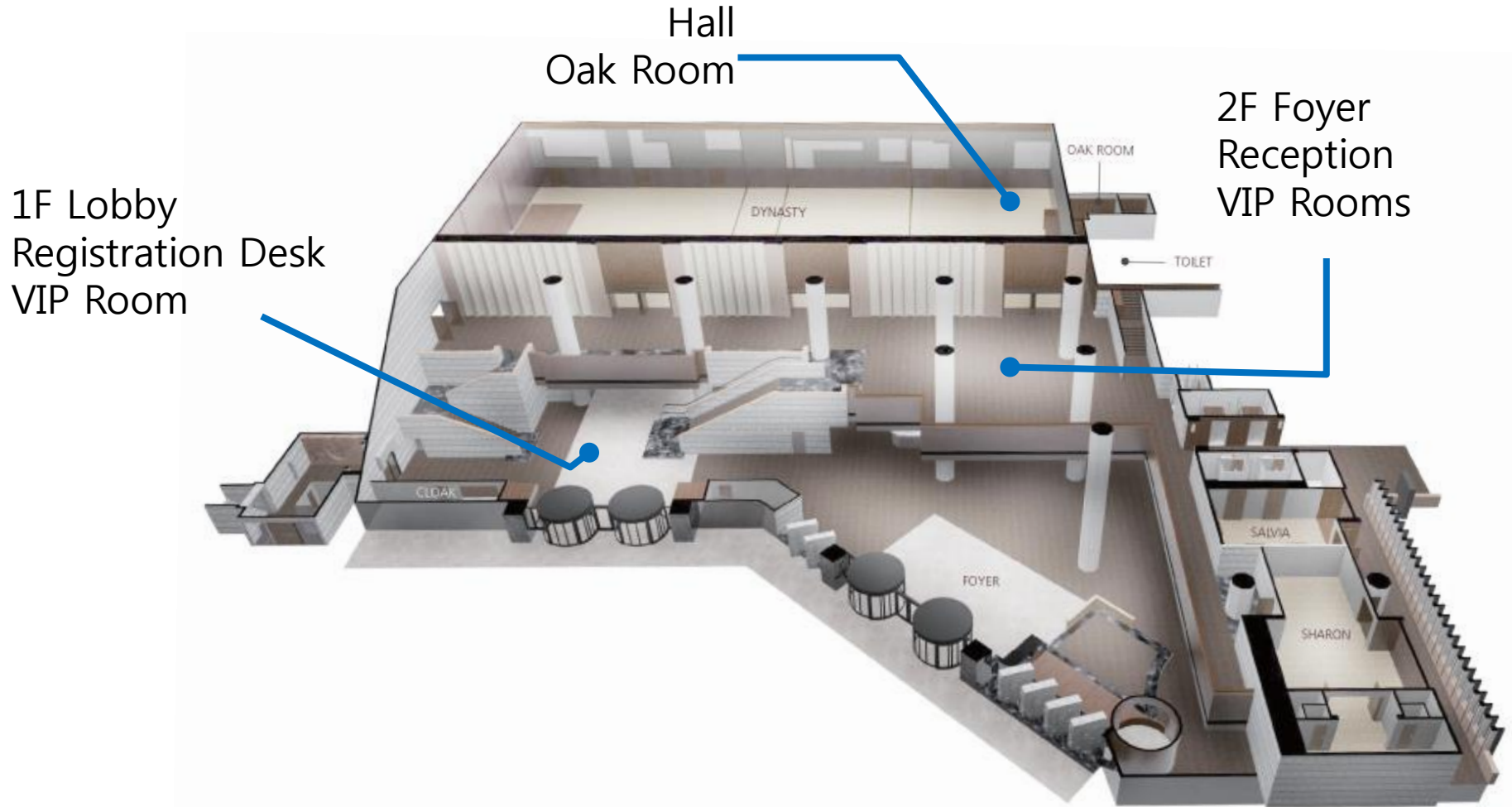

# 1F LOBBY

## 1F Registration Desk

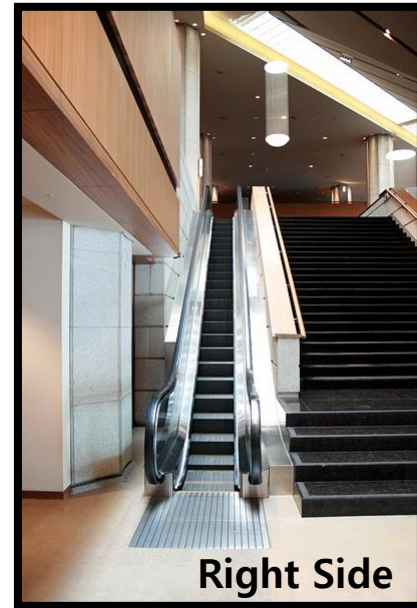
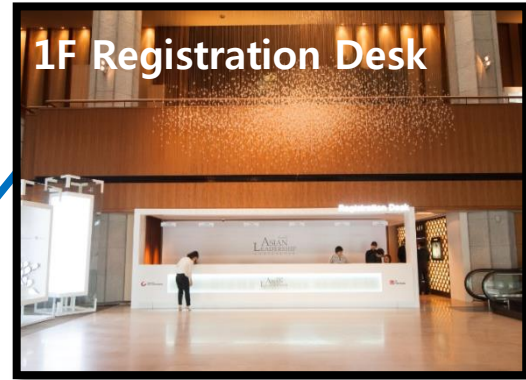

Right Side

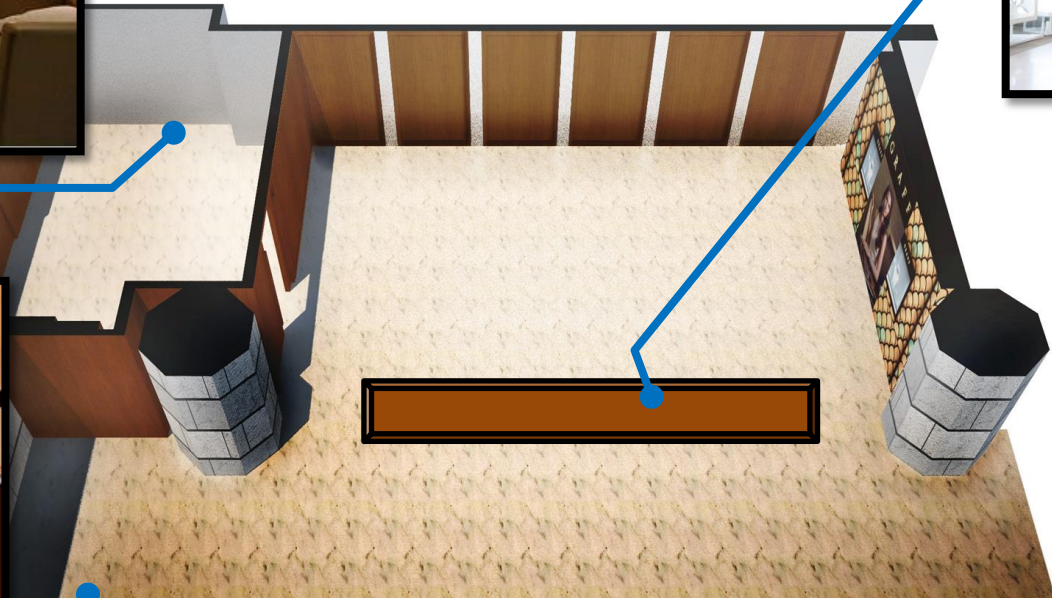

1층 VIP Room

Left Side

Cloak Room

GATE B

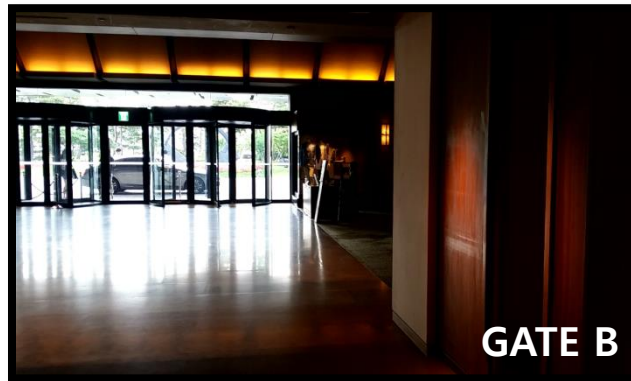

# DYNASTY 1F LOBBY

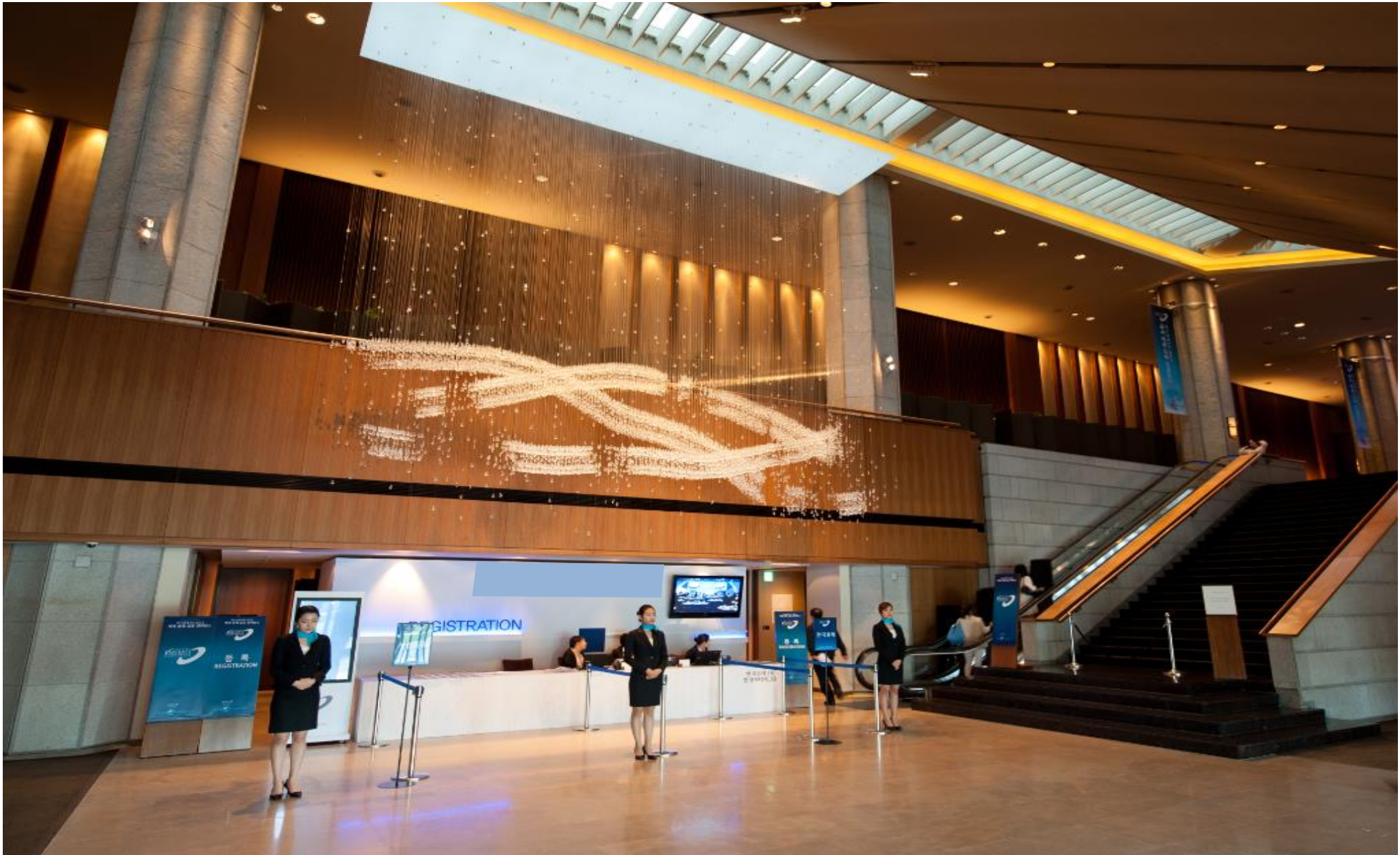



# 2F LOBBY

Oak Room (VIP Room)



VIP Room

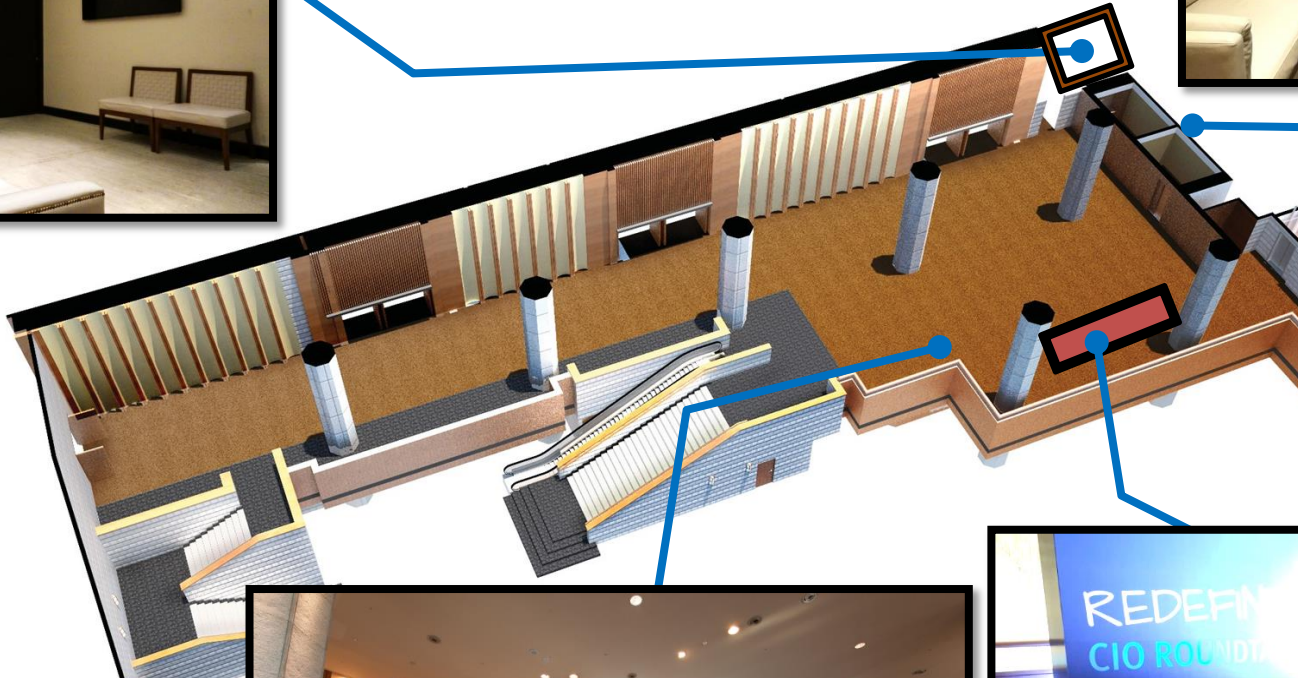

2F Foyer



2F Registration Desk

# DYNASTY 2F Foyer



# Dinner with Performance



# Conference



# Tripartite Conference

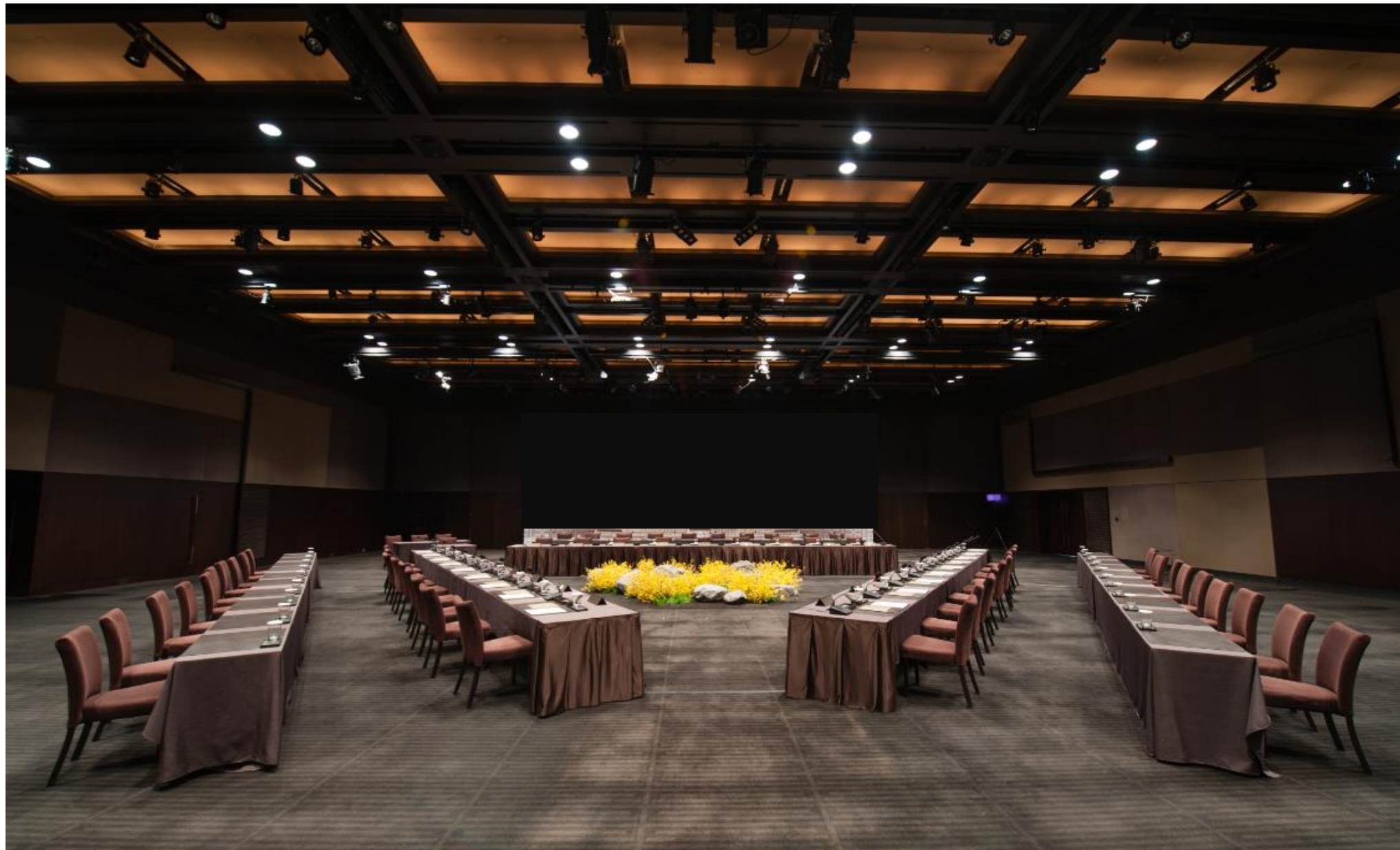

# Gala Dinner



# Fashion Show



## 3<sup>RD</sup> FLOOR BANQUET ROOMS

The natural décor of the banquet and meeting rooms on the 3<sup>rd</sup> floor exudes an air of modernity and refinement.





## 3<sup>RD</sup> FLOOR BANQUET ROOMS

The natural décor of the banquet and meeting rooms on the 3<sup>rd</sup> floor exudes an air of modernity and refinement.

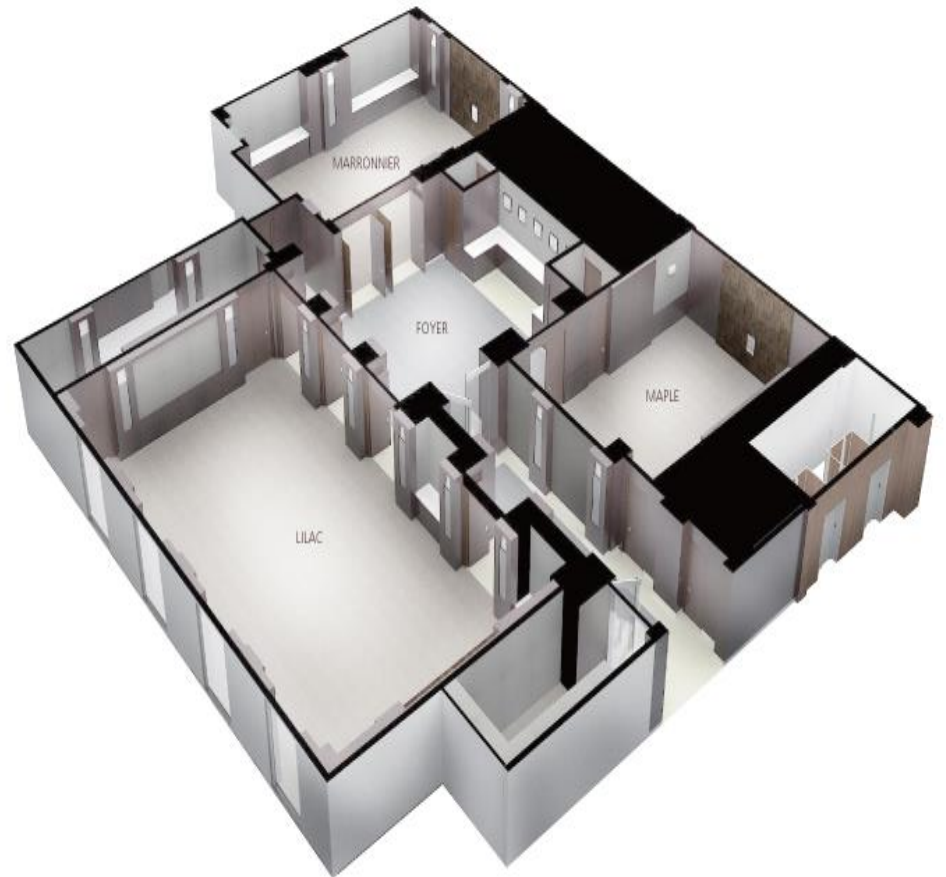

# LILAC

The spacious Lilac room, with its beautiful view of Mt. Namsan and the sophisticated, professional services of our staff, is the optimal venue for large conferences.

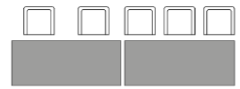
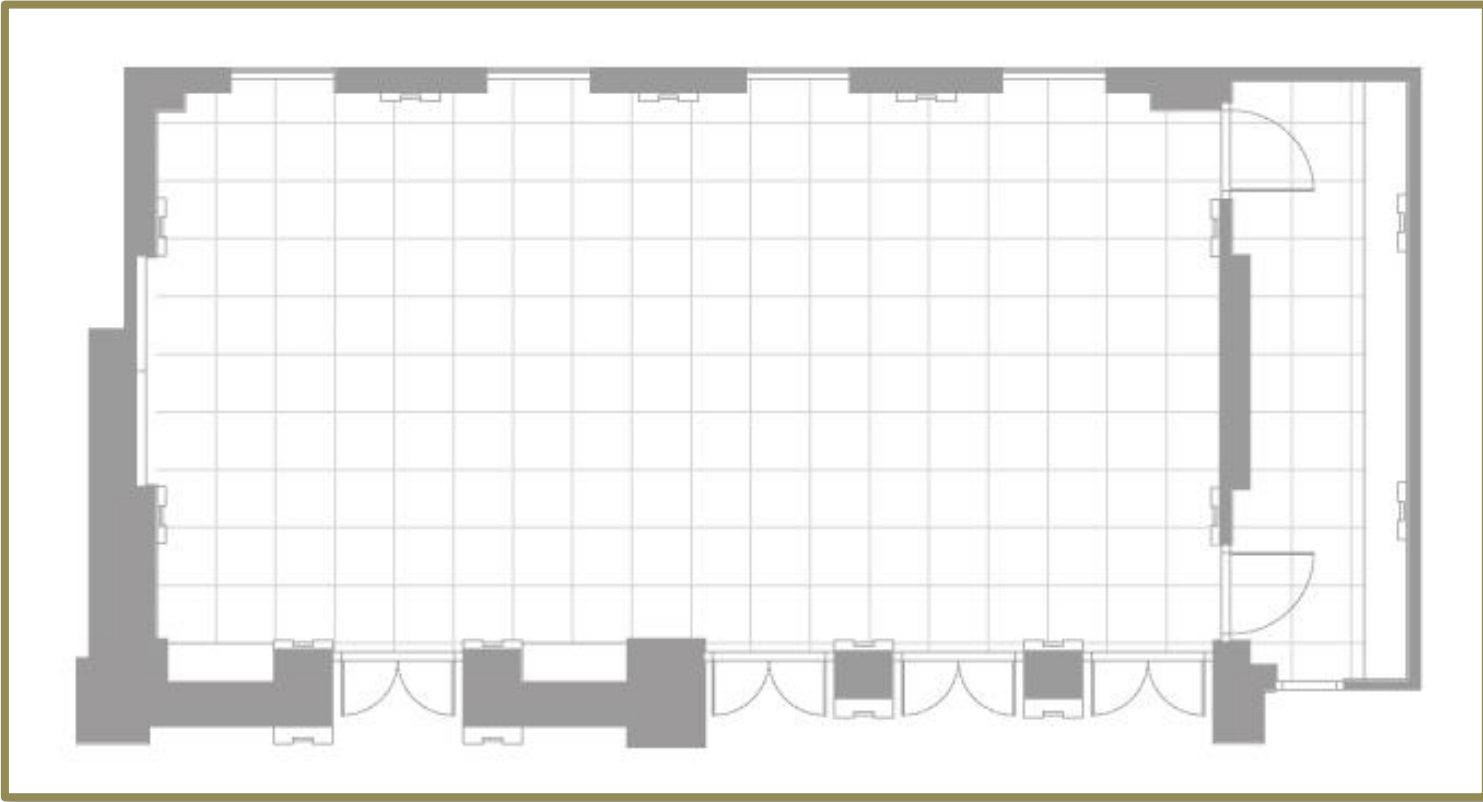
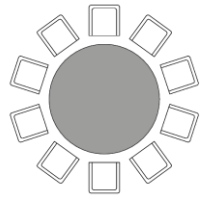
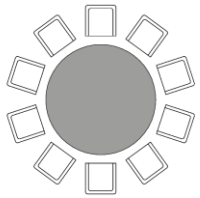
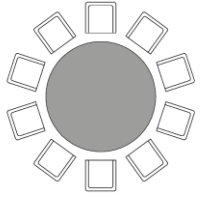

SQM2	PYUNG	AREA	HEIGHT	ROUND TABLE	CLASS ROOM	THEATER / RECEPTION	U-SHAPE	MIC (ea)	SCREEN (m)	BANNER (m)
180	54	9.3×17.5	3.2	120	108	150	35 ~ 40	Wire 4 Wireless 4	Front 5.5×3 Back 5.5×3	6×0.7

# LILAC

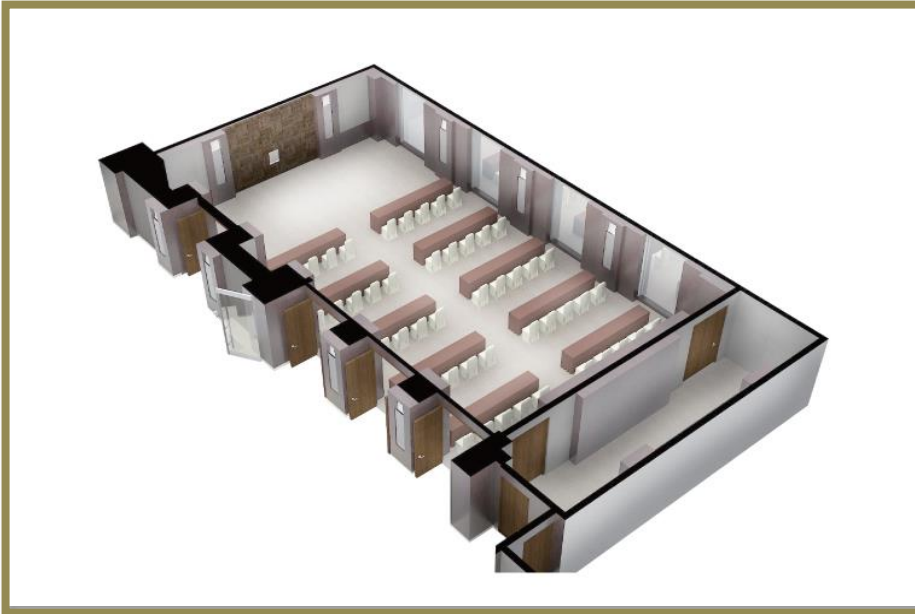
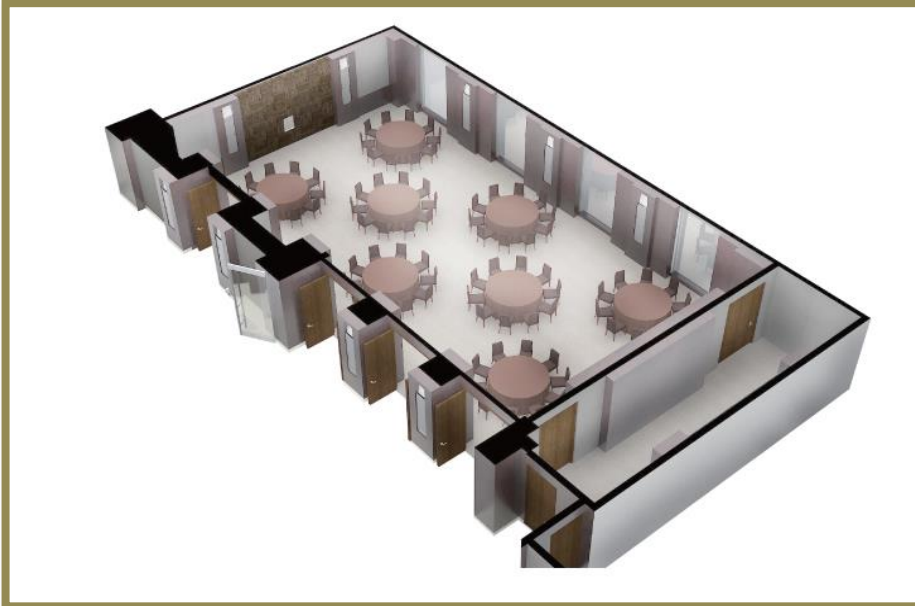

# Seminar



# MARRONNIER

The hall's modern interior, nature-friendly materials and subdued lighting create a relaxing environment of refined beauty, making it the ideal venue for high-end seminars and business events.

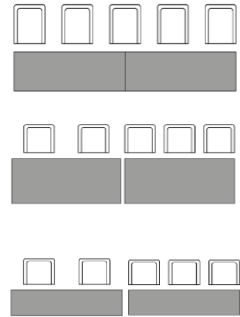
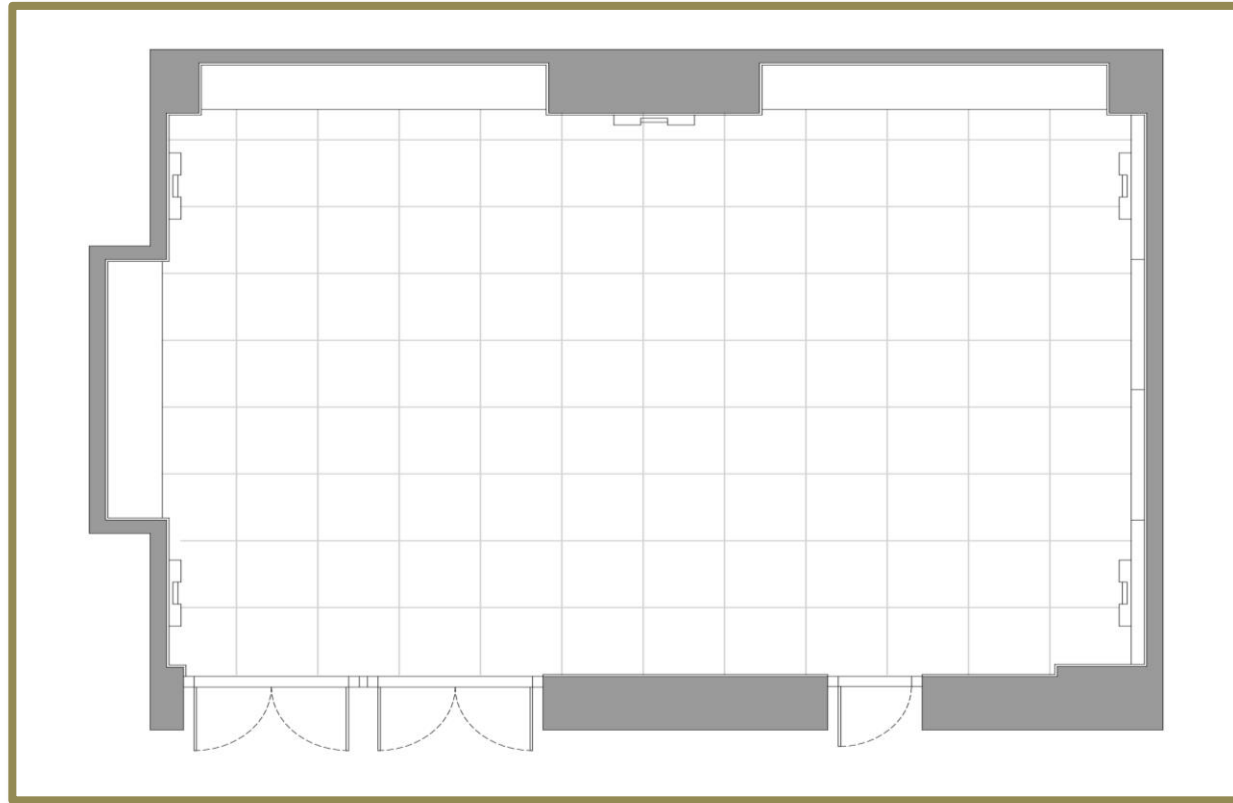
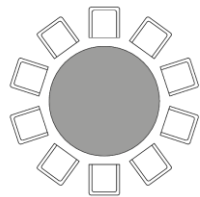
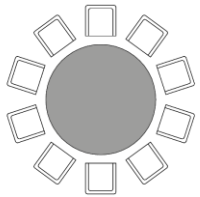
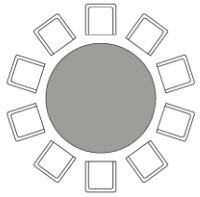

SQM2	PYUNG	AREA	HEIGHT	ROUND TABLE	CLASS ROOM	THEATER / RECEPTION	U-SHAPE	MIC (ea)	SCREEN (m)	BANNER (m)
106	32	8.3×12	2.8	60	70	80	25 ~ 28	Wire 4 Wireless 4	4.6×2.2	6×0.7

# MARRONNIER

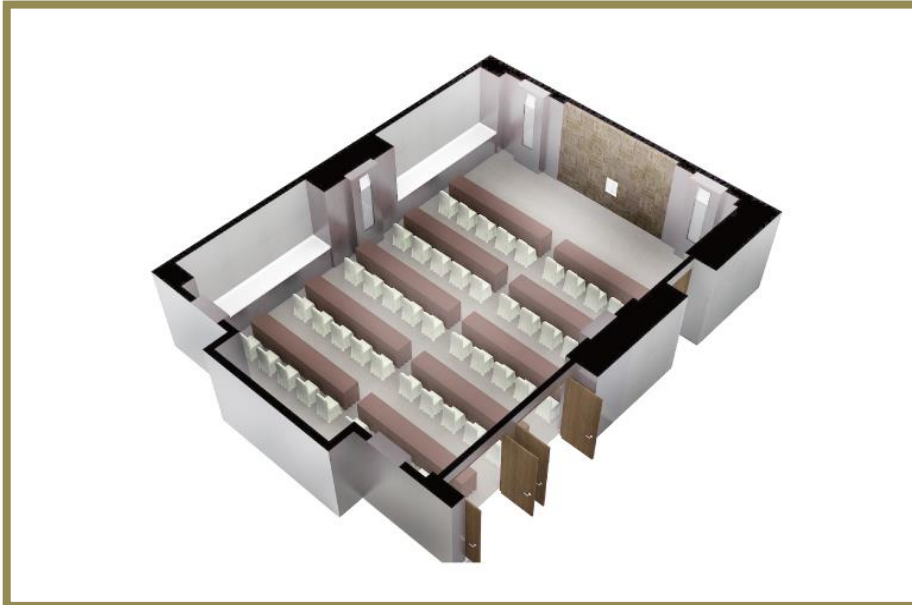
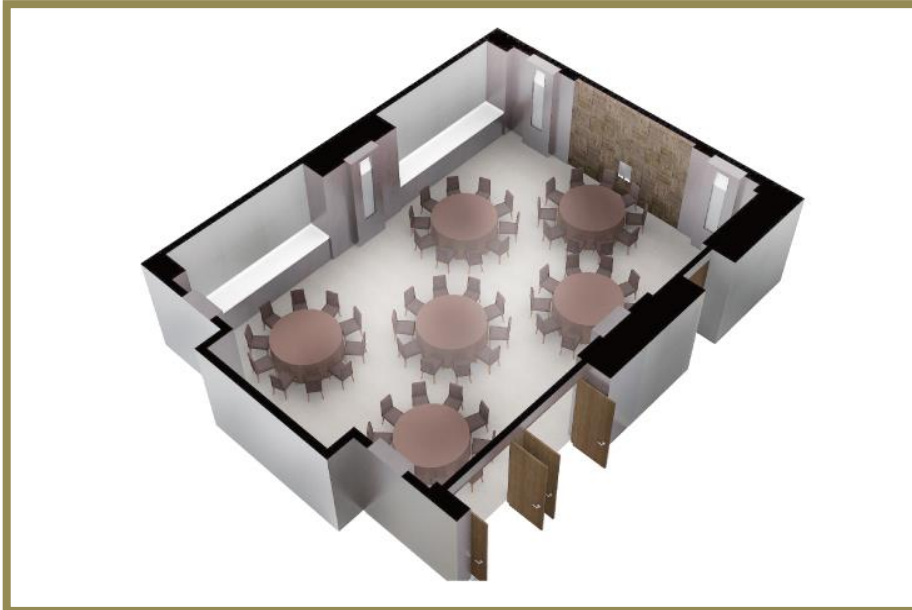

# MAPLE

The simple yet beautiful Maple room is perfect for small meetings that require an atmosphere of comfort and intimacy. The room's simple wooden interior creates a comfortable atmosphere.

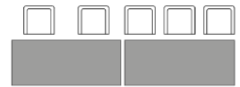
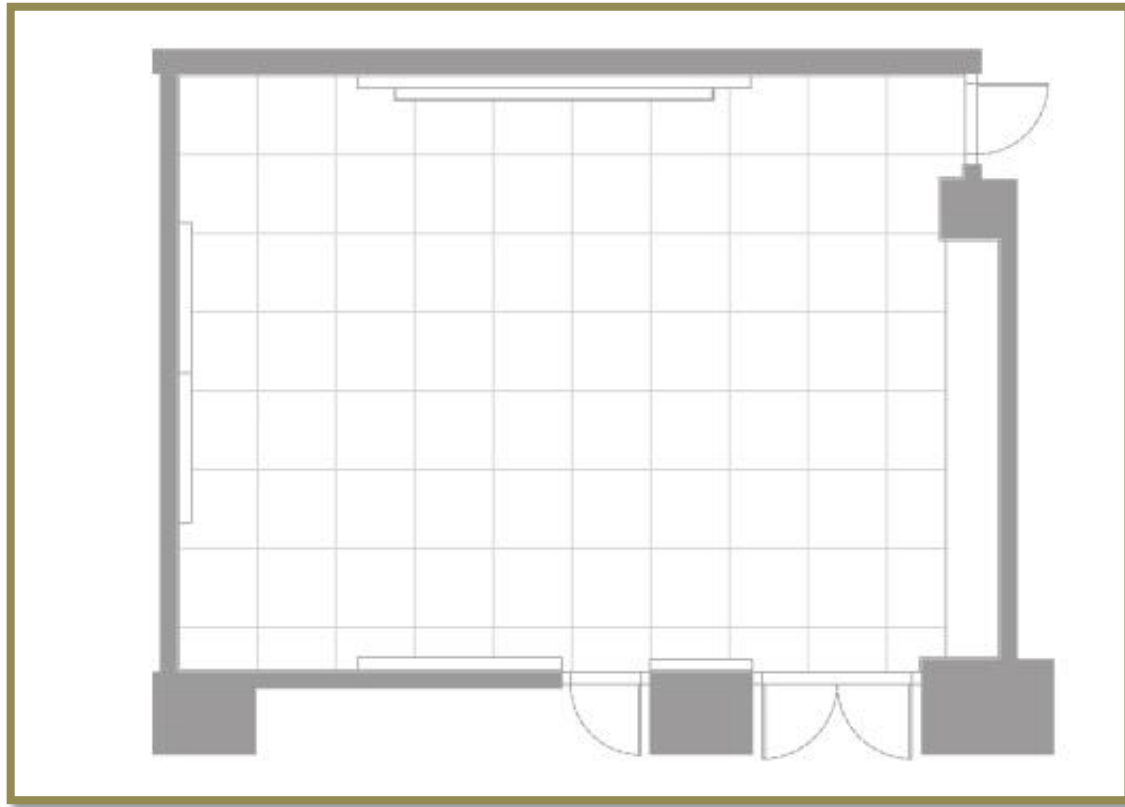
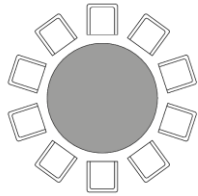
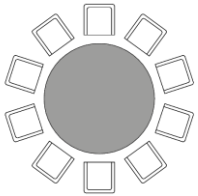
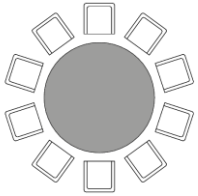

SQM2	PYUNG	AREA	HEIGHT	ROUND TABLE	CLASS ROOM	THEATER / RECEPTION	U-SHAPE	MIC (ea)	SCREEN (m)	BANNER (m)
78	24	7.3×9.8	2.8	40	36	50	20 ~ 23	Wire 4 Wireless 4	4.6×2.2	6×0.7

# MAPLE

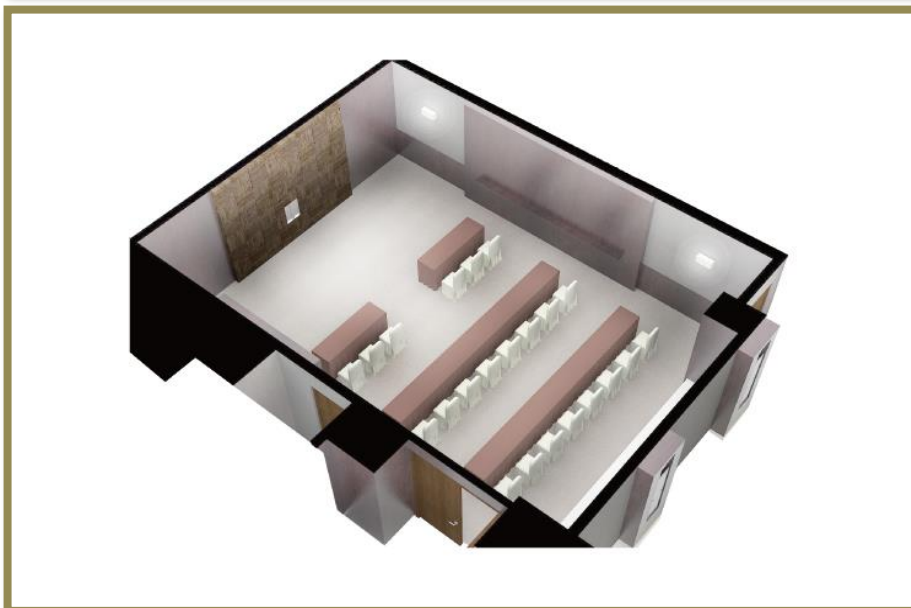
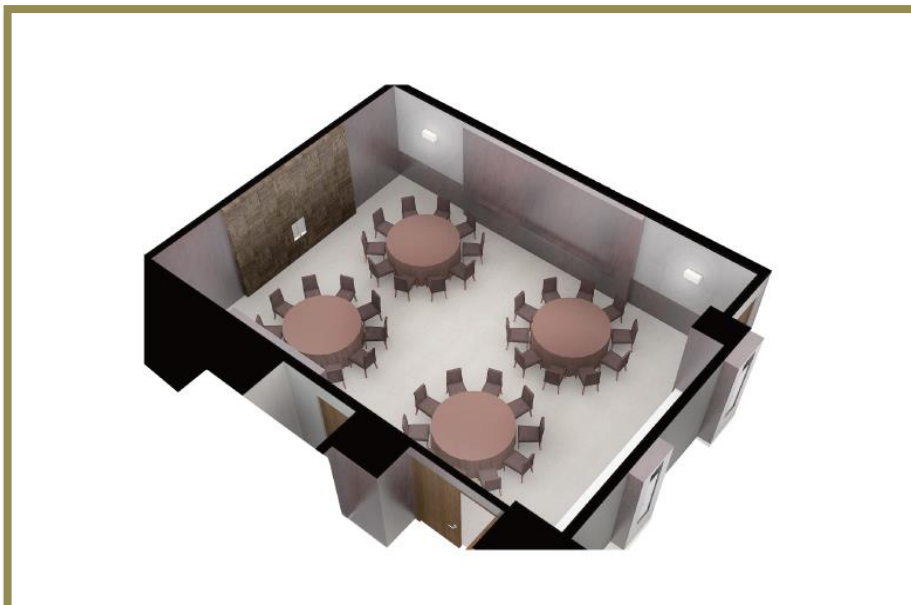



# Board Meeting



## BUSINESS ROOM

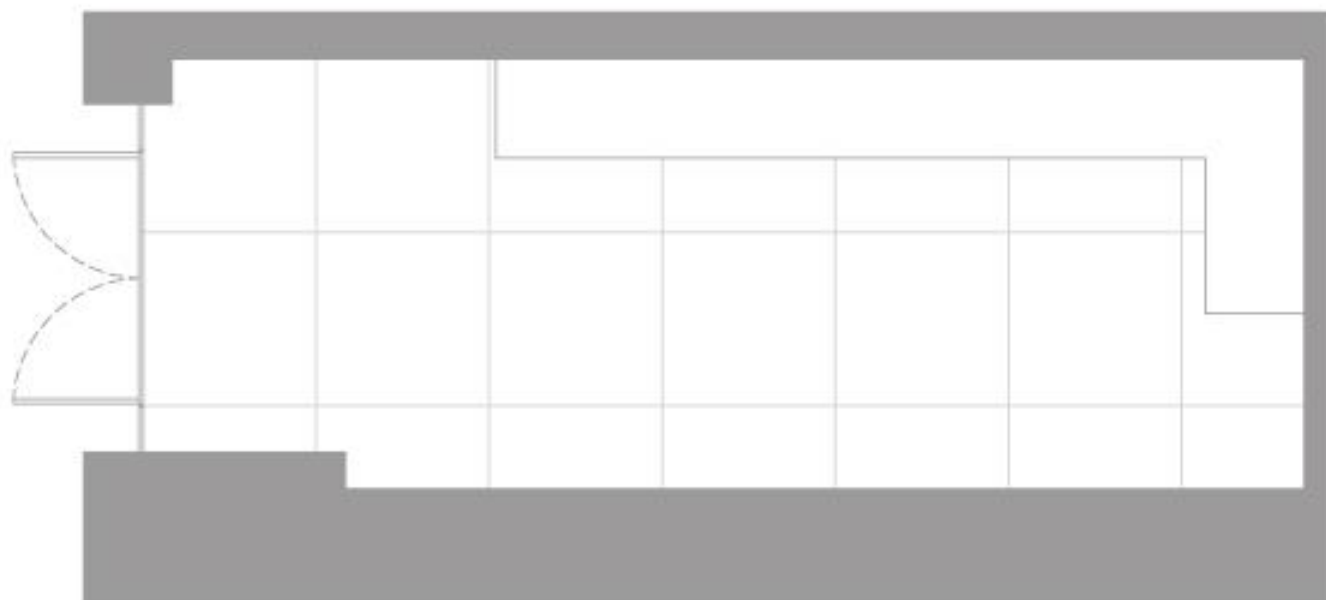

CEILING HEIGHTS

AREA

SIZE

2.8m (9.1ft)

16.3m<sup>2</sup> (4.9py)

6.7 x 2.4m (21.9 x 7.8ft)

**MAIN BLDG**  
3F LOBBY

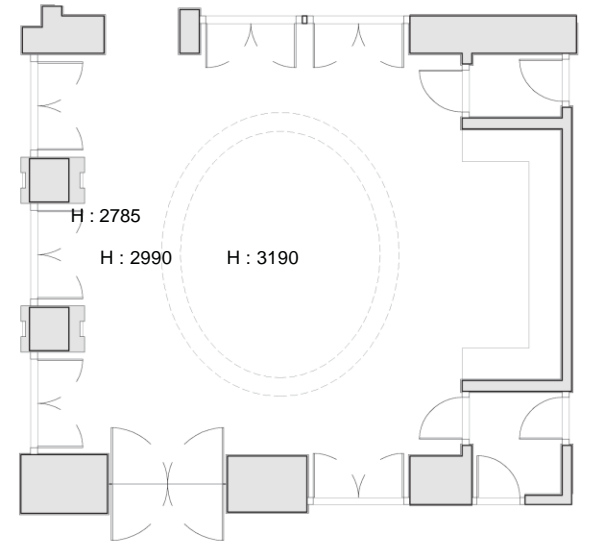
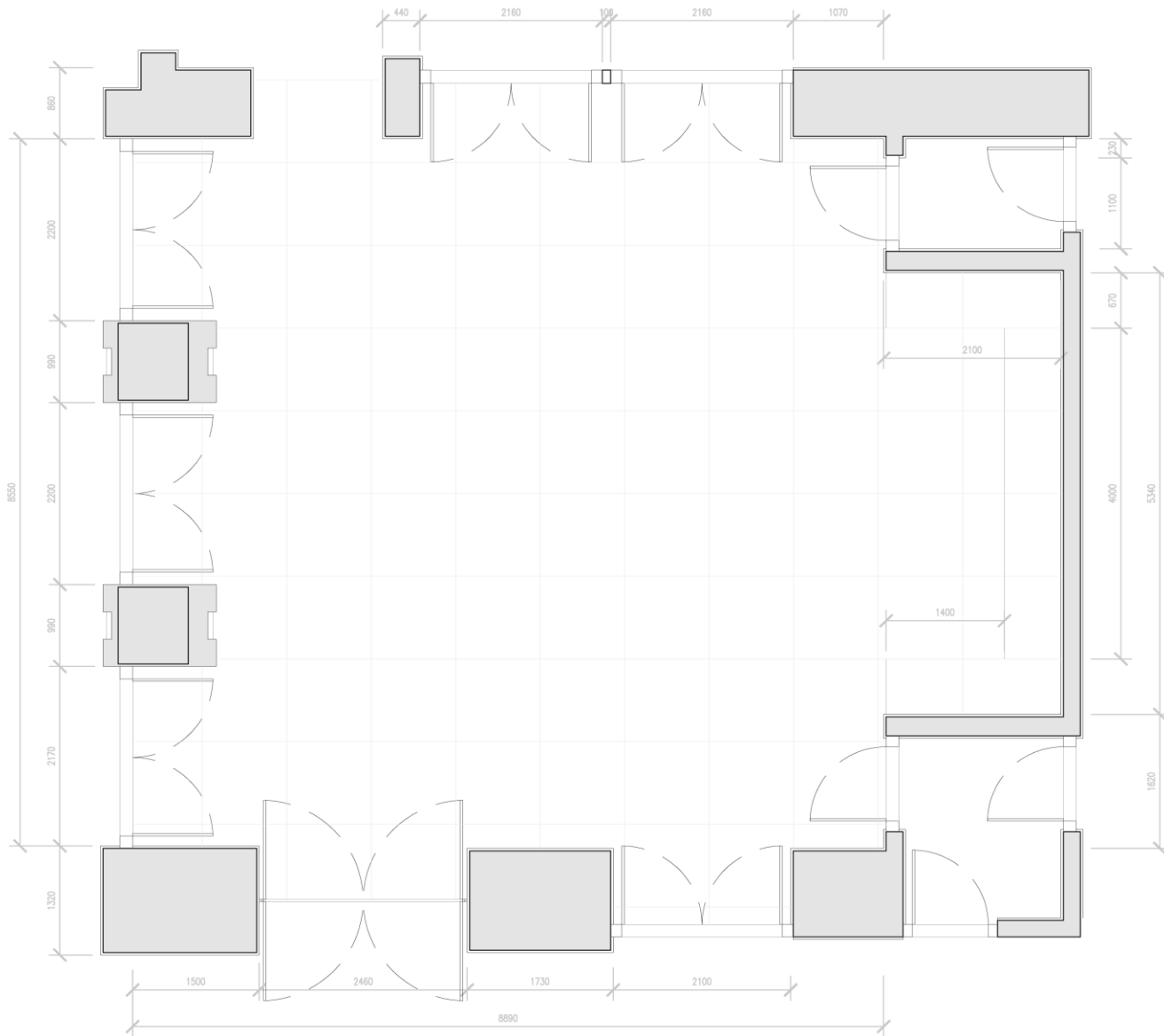

Surface

76.6 m<sup>2</sup>

Size

8.9 x 8.6 x 2.8  
m

## YEONG BIN GWAN

Yeong Bin Gwan was established in 1967 as a venue for receiving VIPs and visiting heads of state. Since the Samsung Group's takeover of the hotel in 1973, and the opening of the Shilla Seoul, it has served as a public venue for high-profile conferences, banquets and outdoor celebrations.



# YEONG BIN GWAN

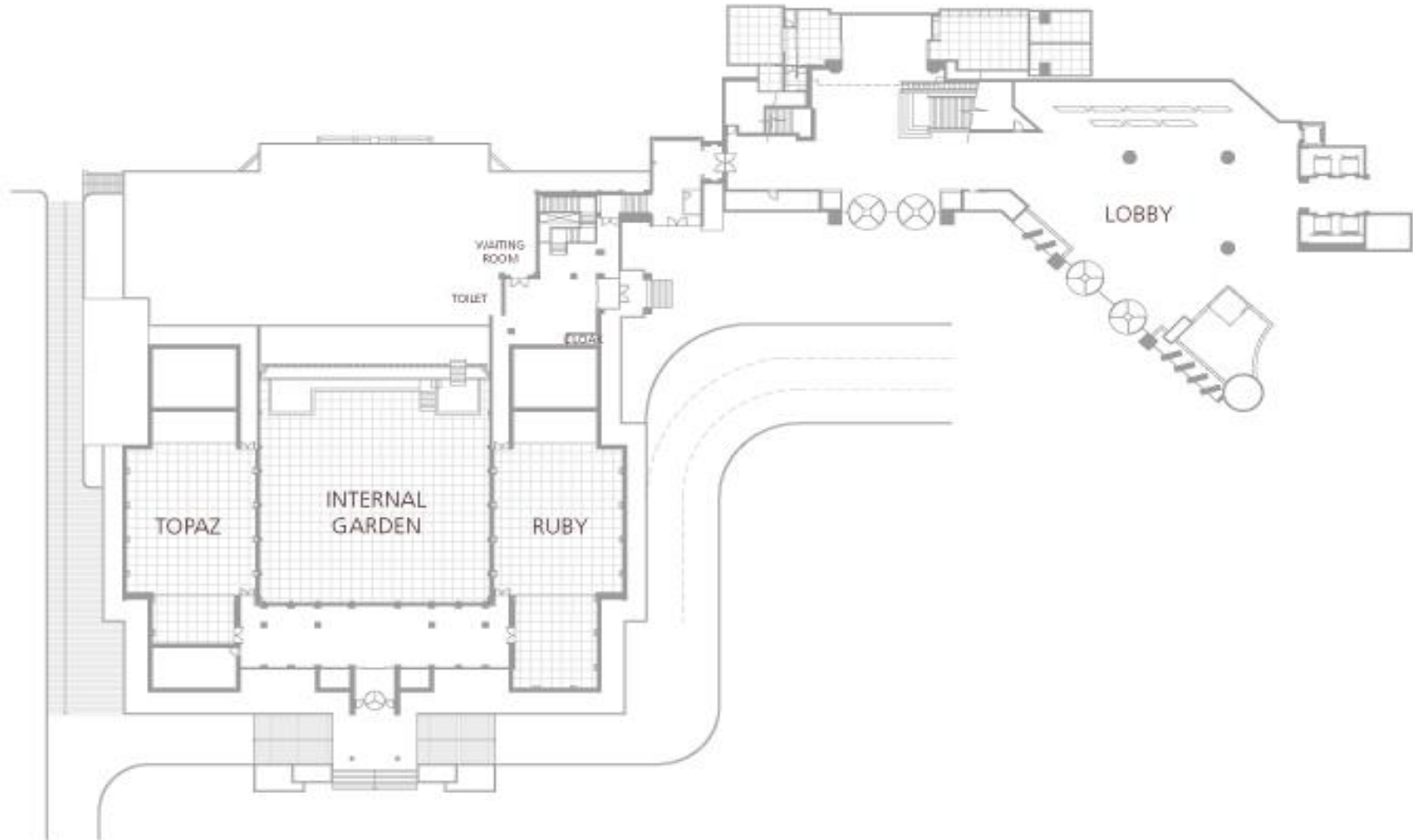

# YEONG BIN GWAN

2F VIP Room



1F VIP Room



Registration Desk



TOPAZ

INTERNAL GARDEN

RUBY

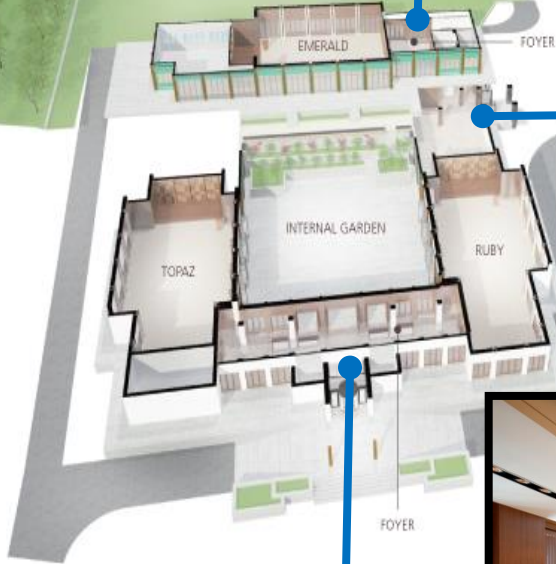

1F Foyer (RUBY & TOPAZ)

Main Gate for EMERALD

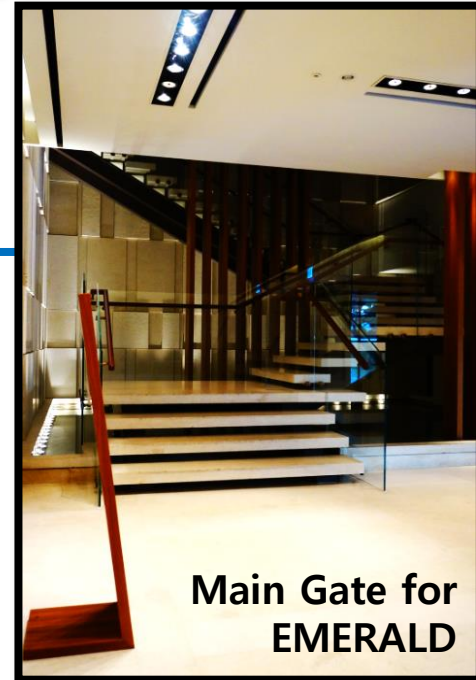

# RUBY

The Ruby Hall's subdued traditional atmosphere brings an air of quiet elegance to any celebration.

Perfectly suited to cocktail parties, receptions or any small to medium-sized event.

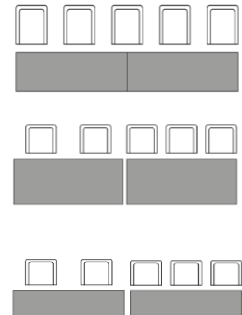
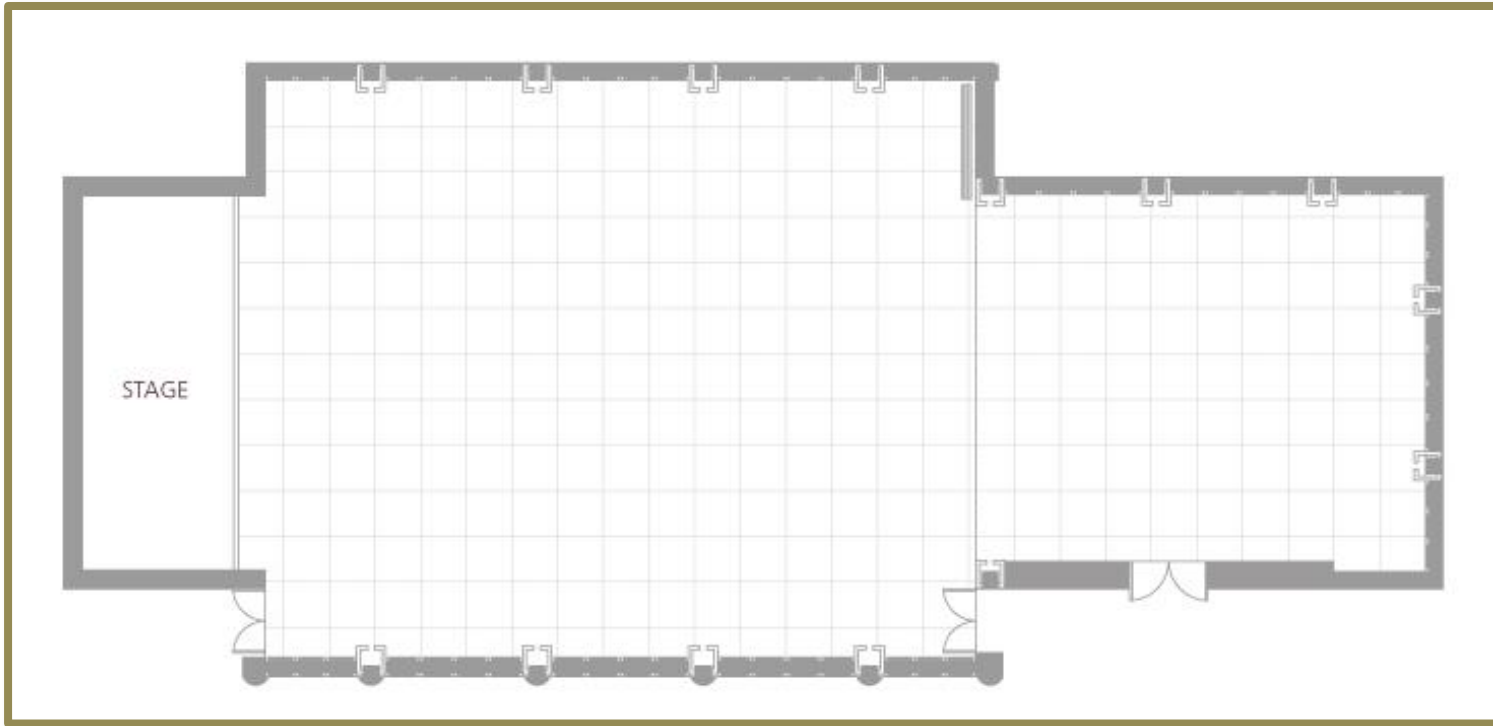
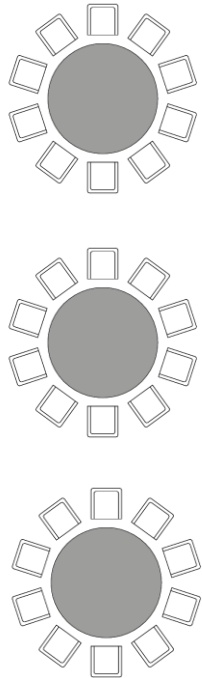

SQM2	PYUNG	AREA	HEIGHT	ROUND TABLE	CLASS ROOM	THEATER / RECEPTION	U-SHAPE	MIC (ea)	SCREEN (m)	BANNER (m)
300	103	Main : 12.2×15.7 Opal : 7.7×9	4.6	190	200	300	45	Wire 4 Wireless 4	Front 4.6×3 Right 5.2×3.7 Back 4.6×3	8×0.7

# TOPAZ

The Topaz Hall is designed for elegant, high-end events in a traditional Korean atmosphere.

Combining Korean sentiment with a modern feel, the Topaz Hall is ideal for embassy events, luxury brand launch events or any soiree that demands a sense of heightened elegance.

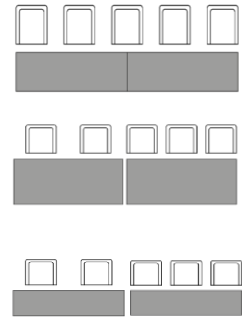
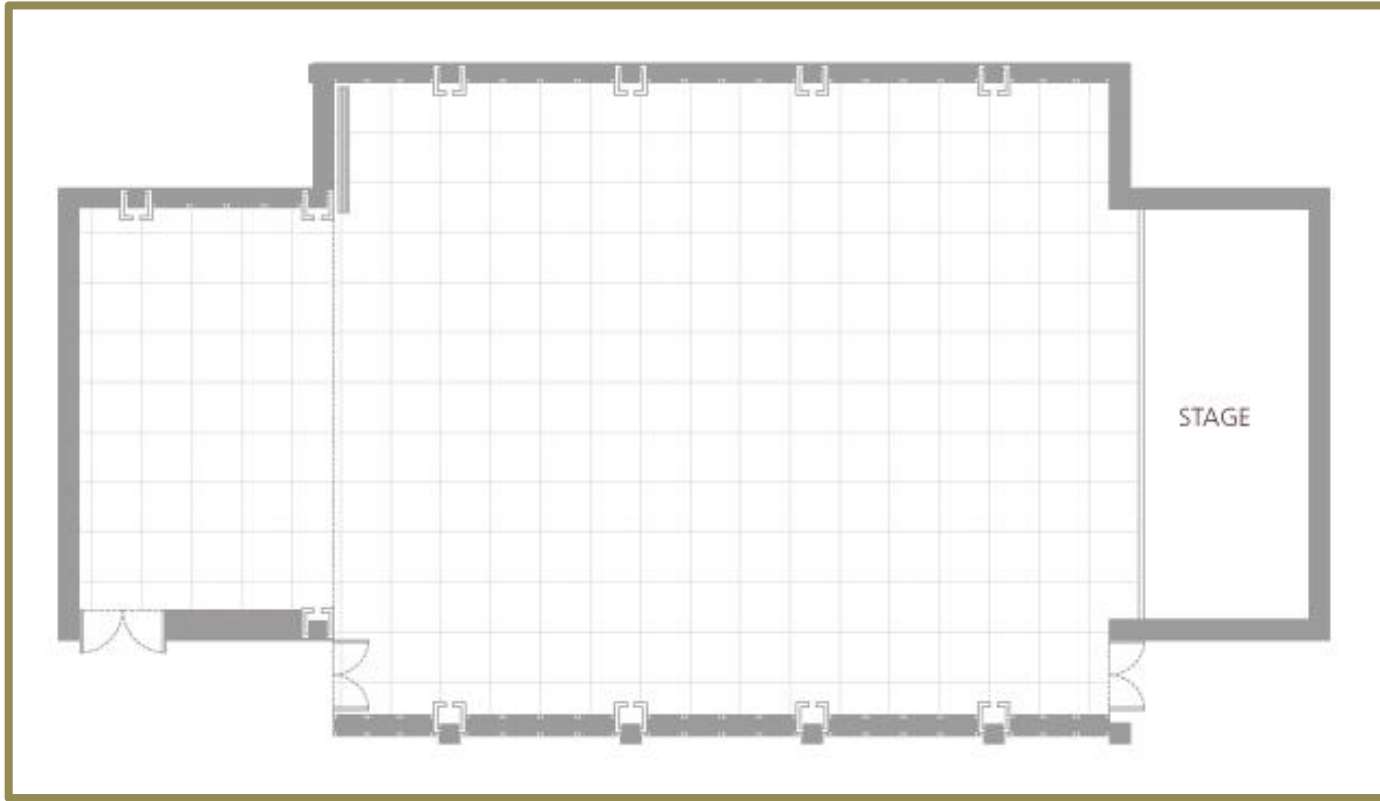
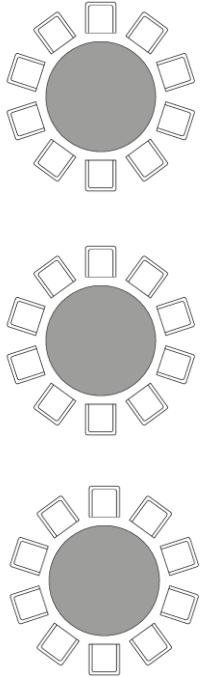

SQM2	PYUNG	AREA	HEIGHT	ROUND TABLE	CLASS ROOM	THEATER / RECEPTION	U-SHAPE	MIC (ea)	SCREEN (m)	BANNER (m)
300	103	Main : 12.2×15.7 Opal : 7.7×5	4.6	160	170	250	45	Wire 4 Wireless 4	Front 4.6×3 Right 5.2×3.7 Back 4.6×3	8×0.7



RUBY



TOPAZ

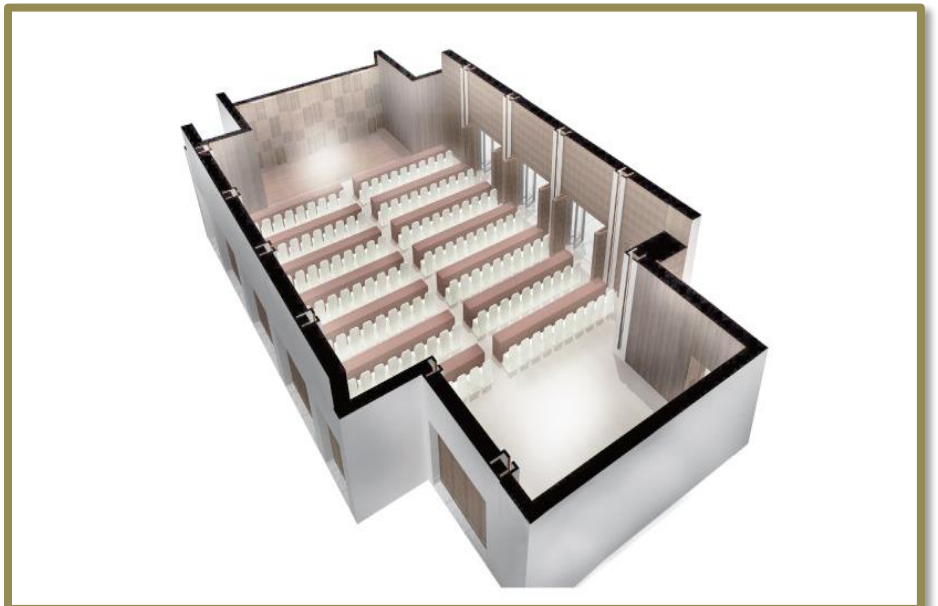
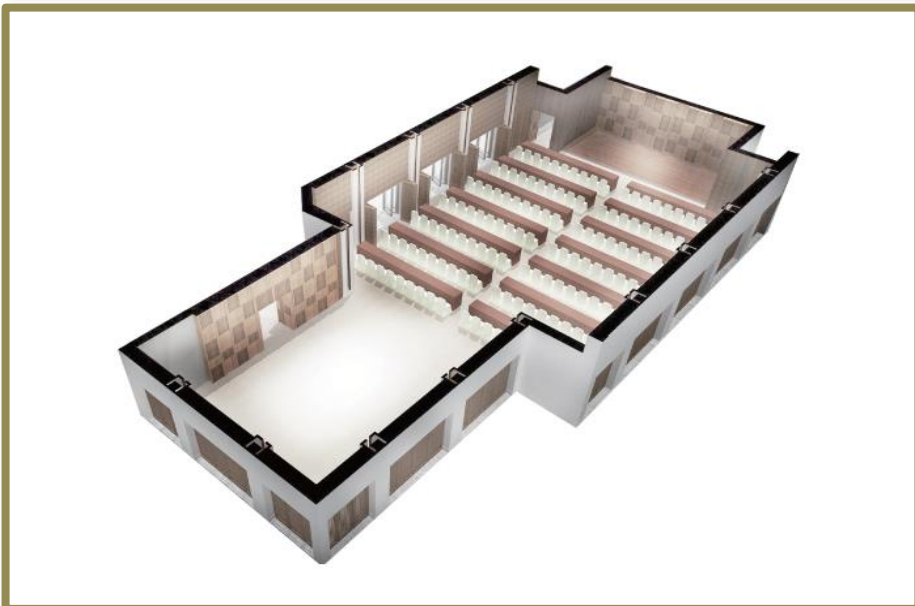
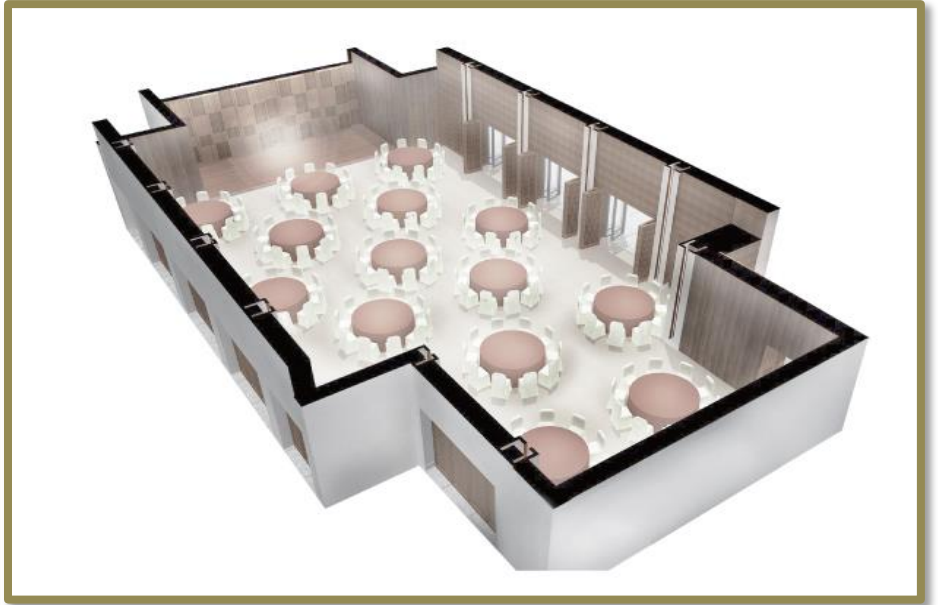

# Seminar



# Launching Event



# Conference



# Conference



# Launching Event



# Launching Event



# Press Conference





# EMERALD

The Emerald Hall is the perfect meeting room, featuring both traditional beauty and high-tech functionality. It is equipped with all the facilities required for international conferences and features a warm environment of natural-colored wood.

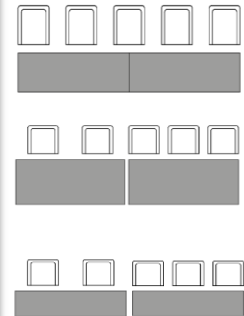
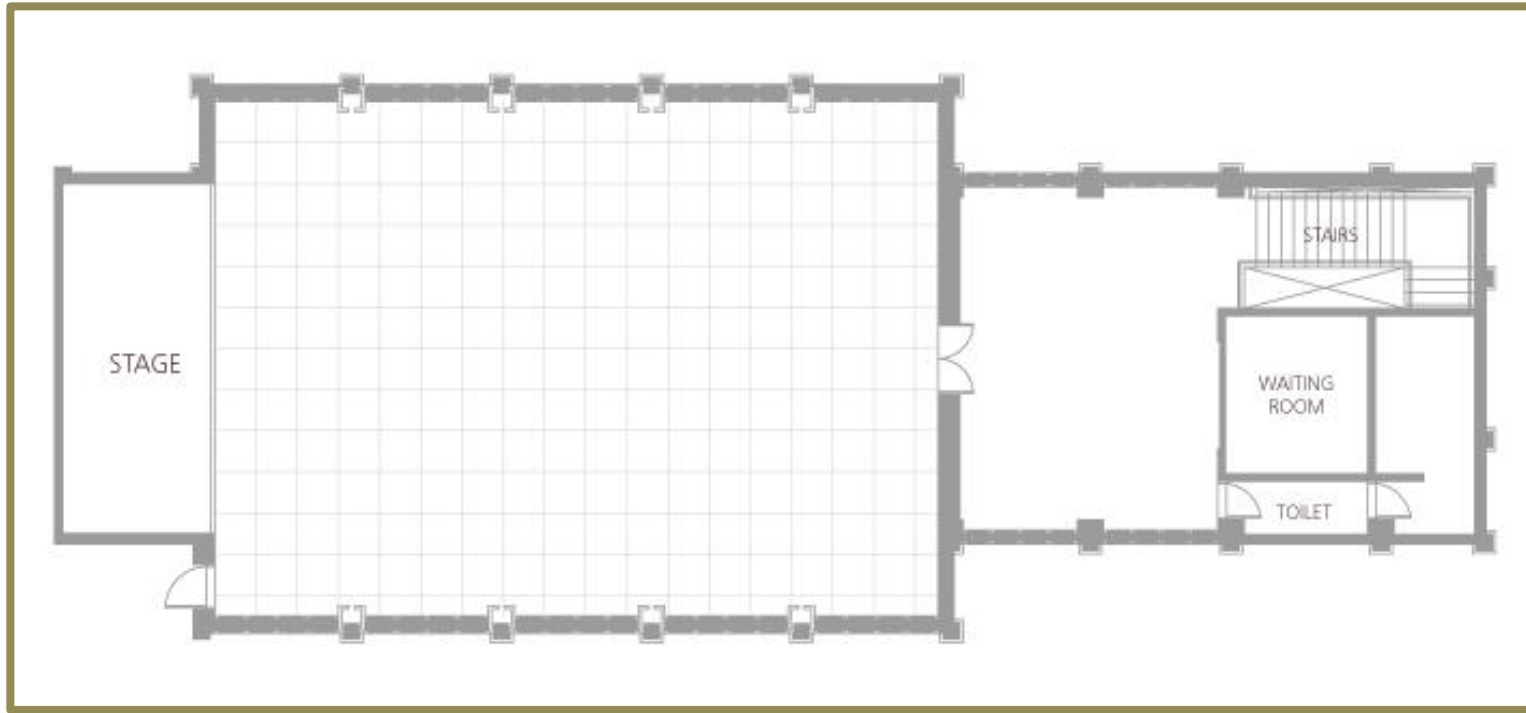
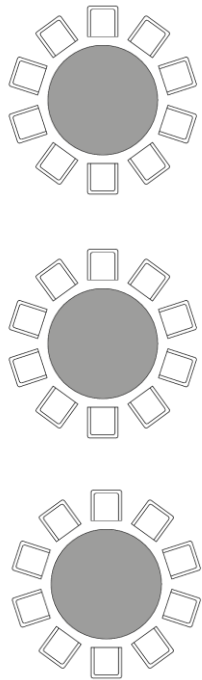

SQM2	PYUNG	AREA	HEIGHT	ROUND TABLE	CLASS ROOM	THEATER / RECEPTION	U-SHAPE	MIC (ea)	SCREEN (m)	BANNER (m)
233	85	12×17.8	4.2	160	160	240	45	Wire 4 Wireless 4	Front 4.6×3 Left 5.2×3.7	8×0.7

# EMERALD

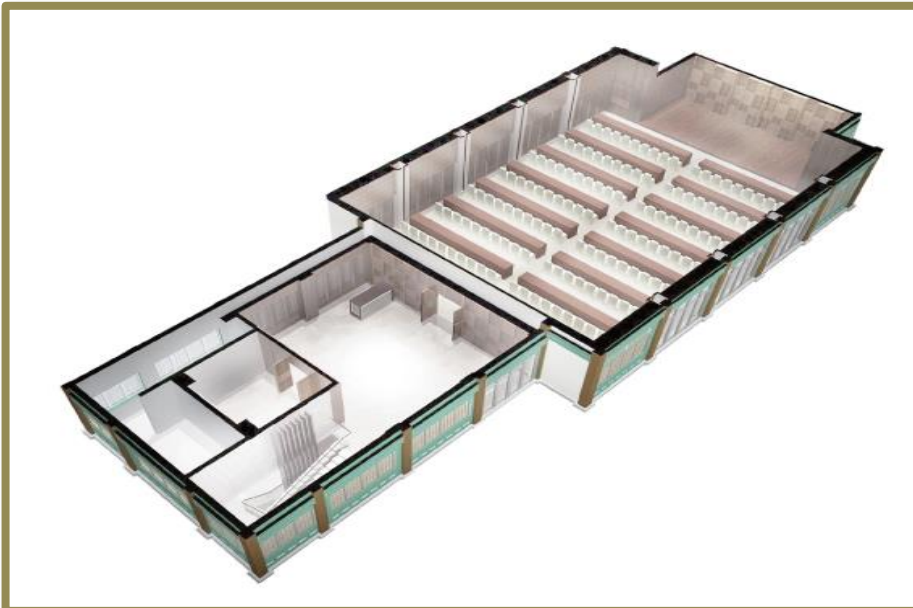

# Luxury Brand Launching



# GARDEN

Beautiful sculptures dotting the landscape and a spacious lawn are just two of the features that can only be found at the Shilla Seoul.

Any event takes on a garden party atmosphere when held in our gardens

INTERNAL GARDEN

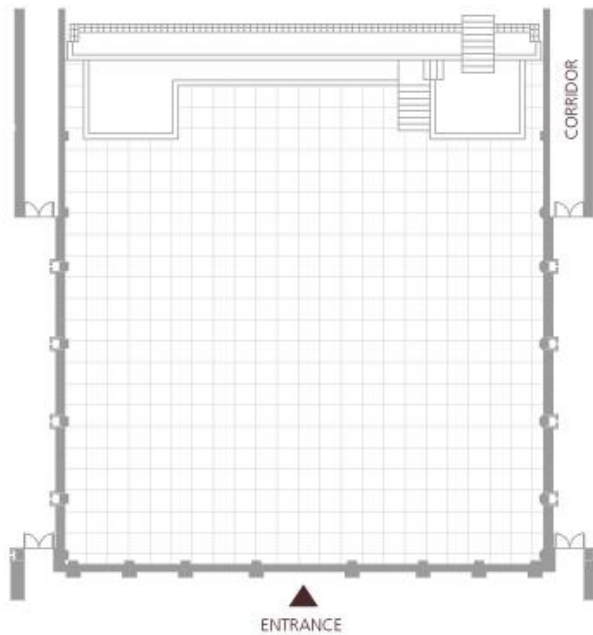

AREA	SIZE
506.3m <sup>2</sup> (153.1py)	22.5 x 22.5m (73.8 x 73.8ft)

EXTERIOR GARDEN

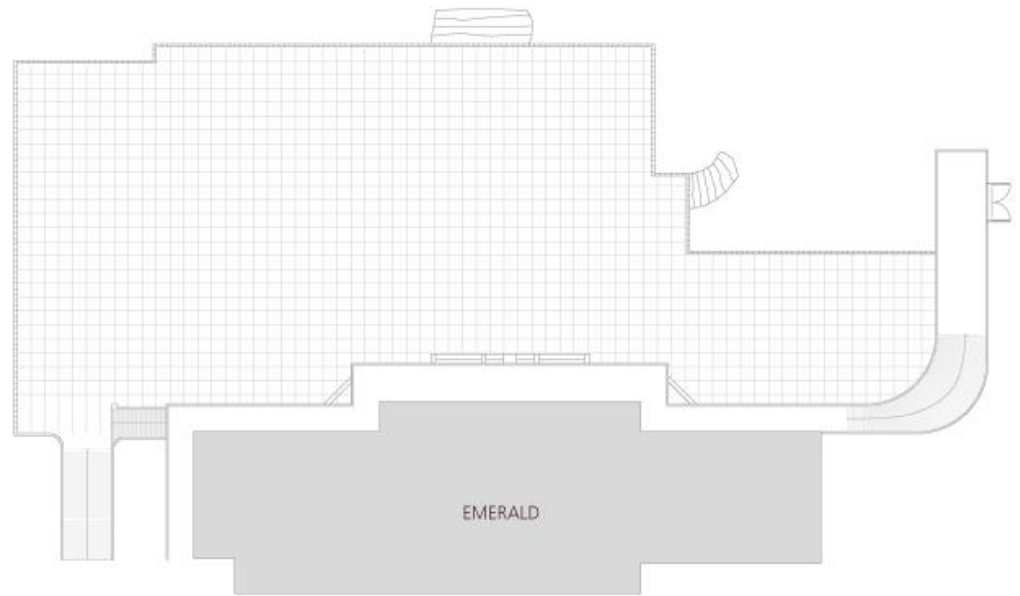

AREA	SIZE
1325.8m <sup>2</sup> (401.0py)	66.0 x 25.7m (216.5 x 84.3ft)

# GARDEN

Internal Garden with LUBY & TOPAZ



External Garden with EMERALD



# Internal Garden



# Internal Garden



# External Garden





# External Garden



# External Garden

