









ROCK YOUR BODY!

ROCK YOUR BODY!

ROCK YOUR BODY!



















Axonometry



MIXD

Mercury  
HOTELS



## Visualisation

Lobby - Reception counter



# Visualisation

Lobby - Bar







Visualisation  
Foyer





Visualization  
Lift lobby



Concept  
Restaurant



Concept  
Restaurant



Concept  
Restaurant



Preconcept

Bar













# FLOOR PLAN

CAPACITY		LONDON	FOYER	1, 2, 3, 4, 5, 6	7	8	9	1+2+3, 4+5+6	7+8	7+8+9
		WHOLE HALL	INDIVIDUAL	INDIVIDUAL	INDIVIDUAL	INDIVIDUAL	INDIVIDUAL	COMBINED	COMBINED	COMBINED
Theatre		1200	–	60	180	160	180	140	400	550
Classroom		750	–	24	70	60	70	70	150	250
Cabaret		650	–	32	80	60	80	70	190	300
Round Dinner		800	–	40	120	100	120	130	220	330
Round Dinner Dance		800	–	–	100	90	100	100	180	300
Reception		1200	250	60	200	160	200	150	400	550

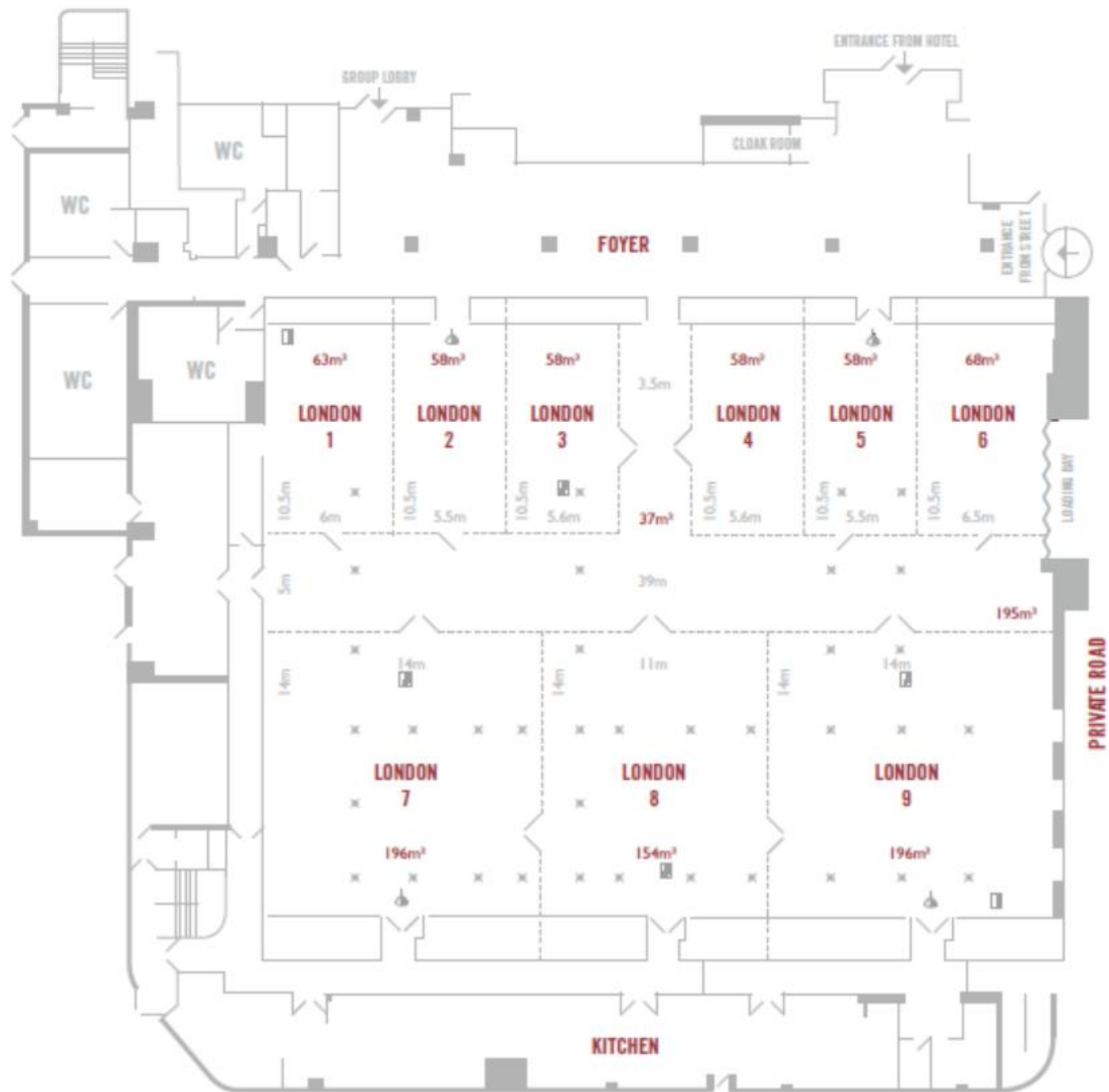

3D Views  
Meeting room



3d views

Meeting room



3d views

Meeting room





3D Views  
Meeting room



### 3D view

Lift lobby



3D view

Corridor



3D view

Corridor



5

Floor	Rooms
7 to 12	Guest Rooms 700 - 1200
6	Guest Rooms 500 - 600
5	Guest Rooms 300 - 400
4	Guest Rooms 100 - 200
3	Meeting Rooms Tables F & B
2	Meeting Rooms Tables F & B
1	Reception Tables F & B
G	

5

In the event  
of a fire  
Do not use this lift



**6**

Bedrooms  
625 - 633

→

Bedrooms  
624 - 624  
Lift to Reception

←



626 > 659 →

← 614 > 624



**Floor**

7 + G	Meeting Room 700 - 720
6	Guest Rooms 500 - 520
5	Guest Rooms 300 - 320
4	Guest Rooms 100 - 120
3	Guest Rooms 200 - 220
2	Meeting Rooms Tables 11 A, 12 A, 13 A, 14 A, 15 A, 16 A
1	Reception Tables 11 A
G	



**6**

**Bedrooms**

601 > 612 ↑

**Floor**

7 + G	Meeting Room 700 - 720
6	Guest Rooms 500 - 520
5	Guest Rooms 300 - 320
4	Guest Rooms 100 - 120
3	Guest Rooms 200 - 220
2	Meeting Rooms Tables 11 A, 12 A, 13 A, 14 A, 15 A, 16 A
1	Reception Tables 11 A
G	



event  
fire

In th  
of